



 **RIDGEGEAR**

PRODUCT BROCHURE

## PIONEERS OF HEIGHT SAFETY

**RIDGEGEAR** was founded in 1998. Since that time, we have established ourselves as a leading innovator in the height safety manufacturing industry. All of our products are developed and produced at our factory in Leek, Staffordshire where they are extensively tested to the highest specification.

### SAFETY

We understand that our products save lives so testing is constant, and repeated again when the production process is complete. The webbing will only be released for one of our products when it passes all of the demanding height safety tests. This ensures our customers benefit from improved functionality and the knowledge that RIDGEGEAR products give absolute security.

### SERVICE

Our aim is to offer a complete solution, with tailored systems designed to meet the individual customer's needs. To respond to all requirements, offer a reliable service and build strong relationships with every business we work with.

### INNOVATION

We are adaptable to new industry concepts and we are continuously enhancing our technical ability and development expertise. We offer a wide range of height safety equipment, whilst constantly improving the performance and design of all of our products.



## DESIGNED FOR A DECADE OUR 10 YEAR WEBBING LIFESPAN

Our webbing offers a 10-year lifespan on all textile based products manufactured on or after January 2010 across the entire RIDGEGEAR harness and lanyard range.

When testing samples of 10 year old products, they all passed EN testing as well as additional tests where they were exposed to UV for an extended amount of time. The results showed that the breaking loads on all of our webbing were between 85-98% of their original value, against the minimum requirement of 70%.



## THE SAFETY OF THE PLANET ECO HARNESSES IN 5 EASY STEPS

Our ECO webbing is produced using ocean plastics, by making a recycled polyester. We now offer ECO webbing across our harness range.



## SETTING STANDARDS ACCREDITATIONS & ASSOCIATESHIPS

As a manufacturer of height safety equipment, we understand the importance of continual improvement. Our BSI ISO 9001 certification shows our commitment to manufacturing quality products and services which save lives.

We also hold memberships with WAHSA (Work at Height Safety Association), and UIAA (International Climbing and Mountaineering Federation), so you can be confident all of our products have passed the necessary research and testing.



## HOME GROWN INNOVATORS PROUD 'MADE IN BRITAIN' MEMBERS

Since April 2016 we have been proud members of the Made in Britain campaign. We have manufactured our products at our factory in Leek, Staffordshire since 1998.



## CONTENTS

SAFETY HARNESSES	1
HARNESS ACCESSORIES	7
ADVENTURE	9
SAFETY LANYARDS	11
KITS	19
WORK POSITIONING	21
ANCHORAGE	22
CONNECTORS	23
ROPE AND ROPE GRABS	27
FALL ARREST BLOCKS	29
RESCUE	33
STORAGE	37
TOOL LANYARD	39
TRAINING	43
USEFUL INFORMATION	45



©2021 RIDGEGEAR Limited

Kinetic is a registered trademark of Marling Leek.

All the information and imagery within this brochure is subject to copyright. While we make every effort to ensure all the information in this brochure is correct and up-to-date, it is always worth checking with us before ordering. We reserve the right to change product specifications when necessary without prior notice.

## SAFETY HARNESSES

Safety harnesses are the foundation of all fall protection systems. This is why RIDGEGEAR, in conjunction with its sister companies, have developed a dynamic and functional range of safety harnesses which allow unparalleled performance and comfort.

We manufacture a number of different harnesses for various tasks when working at height. For faster and easier donning we offer fast fit buckles on most of our harness range.



### REAR D HARNESS, 1 POINT

#### RGH1

The RGH1 is a basic access harness fitted with a rear attachment point. This harness is primarily used with a fall arrest lanyard to provide an operative with basic fall protection. When used in conjunction with a twin lanyard, the harness can be used for tower climbing, scaffold work and general steel erecting.

- / Rear attachment point
- / Lightweight

Accredited to: EN 361: 2002  
Web material: 45mm water repellent polyester  
Weight: 0.9kg  
Sizes\*: Small, Standard, Large & X-Large



### HIGH-VISIBILITY FRONT & REAR D HARNESS, 2 POINT

#### RGH2 GLOW

The innovative RGH2 Glow provides the user with unprecedented levels of visibility in low light areas, helping to create a safer working environment.

- / High visibility webbing with reflective yarn
- / Both front and rear attachment points
- / Lightweight
- / Proposed industry use: Rail industry

Accredited to: EN 361: 2002  
Web material: High visibility 45mm polyester with reflective yarn  
Weight: 1.1kg  
Sizes\*: Small, Standard, Large & X-Large

**GLOW**



\*Please refer to our harness size guide on Page 48.



# RGH2

### FRONT & REAR D HARNESS, 2 POINT

This versatile, lightweight harness is fitted with rear and chest mounted attachment points that extend its working capability. The RGH2 can be used in vertical fall protection operations and where restraint is needed in either vertical or horizontal planes.

- / Both front and rear attachment points
- / Lightweight

Accredited to: EN 361: 2002  
Web material: 45mm polyester  
Weight: 1.1kg  
Sizes\*: Small, Standard, Large & X-Large



## SAFETY HARNESSSES

### FRONT & REAR D HARNESS FOR USERS UP TO 140KG, 2 POINT

#### RGH2 BIGGUY

The RGH2 BigGuy has been specifically designed and tested for bigger guys. Suitable for users up to 140kg when used in conjunction with the Big Guy lanyards.

- / Tested and approved for a user weight up to 140kg
- / Recommended for use with Big Guy lanyards
- / Both front and rear attachment points

Accredited to: EN 361: 2002  
Web material: 45mm polyester  
Weight: 1.1kg  
Sizes\*: Large & X-Large



### FRONT & REAR D HARNESS WITH FAST FIT BUCKLES, 2 POINT

#### RGH2 FAST FIT

The speed and simplicity of this harness makes it the ideal solution where rapid donning and removal is crucial. The attachment points allow conventional lanyard attachment.

- / Fast fit buckles on the chest and legs
- / Simplicity of assembly and adjustment
- / Both front and rear attachment points

Accredited to: EN 361: 2002  
Web material: 45mm polyester  
Weight: 1.3kg  
Sizes\*: Small, Standard, Large & X-Large



### WORK POSITIONING COMFORT HARNESS, 4 POINT

#### RGH15

The RGH15 is a 'step-in' multitask harness with the added benefit of two side D work positioning D rings on a comfortable support pad. This comfortable harness is designed for operatives who spend long hours working at height and in exposed areas. The unique design allows the shoulder straps to follow the user for added comfort.

- / Front, rear and side attachment points
- / Waist, leg and shoulder support pads
- / Adjustable fast fit buckles on leg and front chest straps
- / Adjuster for repositioning of side D rings
- / Tail ties

Accredited to: EN 361: 2002  
EN 358: 2018

Web material: 45mm water repellent polyester

Weight: 2.1kg  
Sizes\*: Standard & Large



### FRONT, REAR & SIDE D HARNESS, 4 POINT

#### RGH4

The RGH4 combines the basic fall arrest harness with a comfortable work positioning belt in one unit. The harness is fitted with a front and rear D and two side rings mounted to the belt. This comfortable harness is designed for operatives who spend a lot of time working at height and in exposed areas.

- / Front, rear and side attachment points
- / Work positioning belt
- / Two tool loops
- / Fold back side D rings

Accredited to: EN 361: 2002 & EN 358: 2018

Web material: 45mm water repellent polyester

Weight: 1.75kg Standard buckles  
1.95kg Fast fit buckles

Sizes\*: Small, Standard, Large & X-Large



# RGH6

### DELUXE COMFORT FRONT, REAR & SIDE D HARNESS, 4 POINT

Our deluxe comfort work positioning harness, the RGH6, has been created to be used for prolonged periods of time at height. Comfortable completion of tasks is the aim of this harness. A thicker waist belt gives much needed lumbar support when working in a fixed position for hours at a time. For even more comfort we have included a shoulder pad to give additional support to the upper body. The waist pad comes with extra tool loops, allowing operatives to carry as much equipment as is required for their upcoming task. Quick donning is possible due to the inclusion of fast fit buckles.

- / Premium waist pad
- / Shoulder comfort pad
- / Fast fit buckles
- / Four tool loops
- / Fold back side D rings

Accredited to: EN 361:2002 & EN 358:2018

Web material: 45mm water repellent polyester

Weight: 1.95kg Standard buckles or  
2.15kg Fast fit buckles (as standard)

Sizes\*: Small, Standard, Large & X-Large

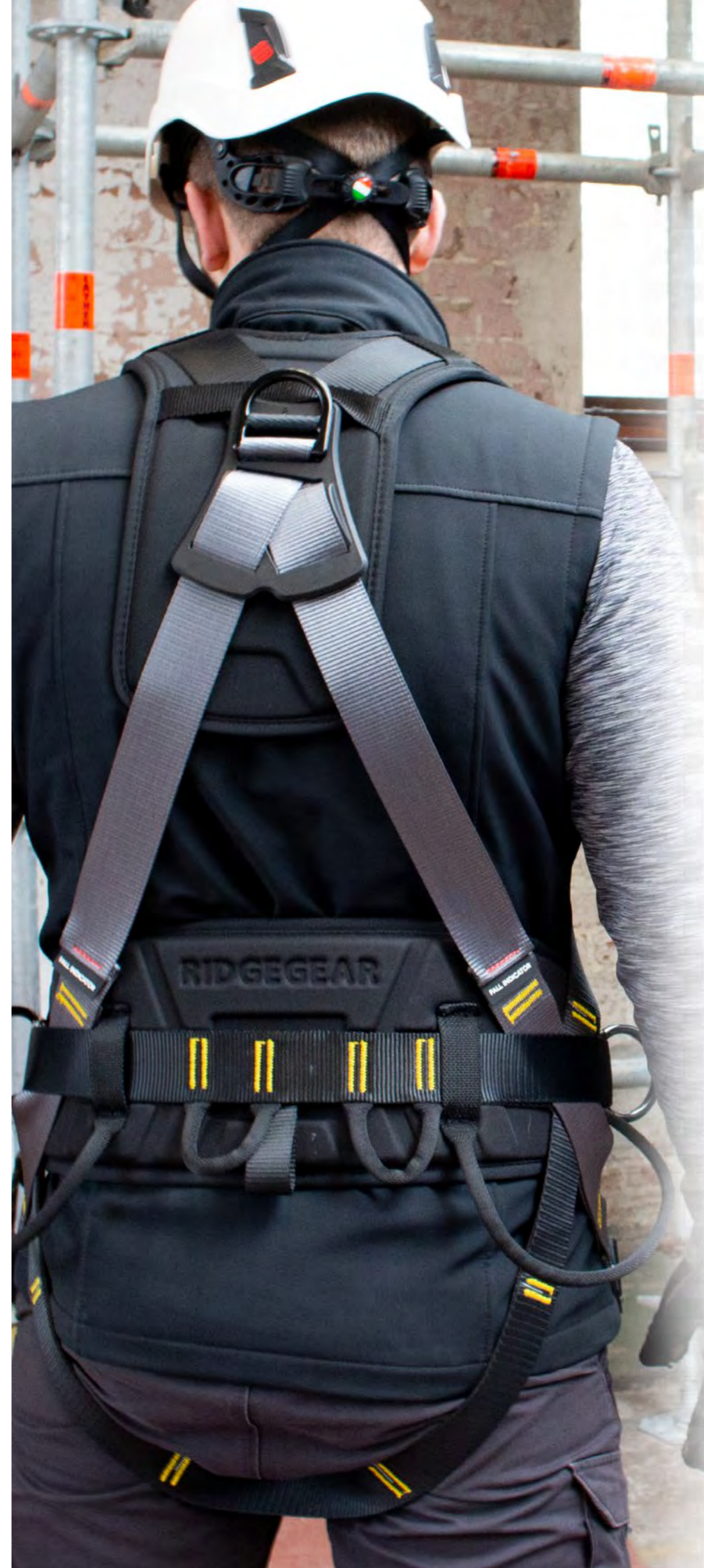

\*Please refer to our harness size guide on Page 48.

## SAFETY HARNESES

### RESCUE HARNESS, 3 POINT

#### RGH5

The RGH5 is designed for use as a confined access harness. The front, rear and rescue attachment points can be used as standard fall arrest points and the rescue strap can be used for lifting and lowering. The rescue loop may also be used for fall arrest under certain conditions.

- / Rescue attachment point with hook and loop fastening
- / Both front and rear attachment points
- / Tail tidies

Accredited to: EN 361: 2002 & EN 1497: 2007

Web material: 45mm water repellent polyester

Weight: 1.2kg

Sizes\*: Small, Standard, Large & X-Large



### HIGH VISIBILITY RESCUE HARNESS, 3 POINT

#### RGH5 GLOW

The RGH5 glow is designed for use as a confined access harness. The reflective yarn woven into the webbing, provides unprecedented levels of visibility in low light areas, helping to create a safer work environment. The rescue loop may also be used for fall arrest under certain conditions.

- / High visibility webbing with reflective yarn
- / Rescue attachment point with hook and loop fastening
- / Both front and rear attachment points
- / Ideal for use in confined spaces
- / Tail tidies

Accredited to: EN 361: 2002 & EN 1497: 2007

Web material: High visibility 45mm polyester with reflective yarn

Weight: 1.2kg

Sizes\*: Small, Standard, Large & X-Large

**GLOW**



### HIGH VISIBILITY AND LUMINOUS RESCUE HARNESS, 3 POINT

#### RGH5 SUPER GLOW

The first of its kind - The RGH5 Super Glow features phosphorescent and reflective yarns that provide extra visibility in low-light conditions. The glow feature works when the phosphorescent webbing takes in light energy and will glow for several hours afterwards.

- / Phosphorescent reflective yarn charged by light energy
- / Fast fit buckles
- / Front & rear attachment point
- / Rescue attachment point with hook and loop fastening
- / Tail tidies

Accredited to: EN 361:2002 & EN 1497:2007

Web material: High visibility 45mm polyester with phosphorescent and reflective yarn

Weight: 1.4kg

Sizes\*: Small, Standard, Large & X-Large



#### RESCUE STRAP

When used, the rescue strap keeps the operative in a near vertical position, which is preferred when recovering an unconscious casualty.

Available on RGH5, RGH5 Glow and RGH5 Super Glow.



# RGH16

### MULTITASK COMFORT HARNESS, 5 POINT

The RGH16 is a 'step-in' multitask harness and will allow operatives to access almost any area in safety using a combination of the RIDGEGEAR products.

In addition there is the added benefit of two side D work positioning D rings on a comfortable side pad, and a further ventral front D ring positioned at the waist for sit suspension and/or work positioning. This comfortable harness is designed for operatives who spend long hours working at height and in exposed areas. The unique design allows the shoulder straps to follow the user for added comfort.

- / Front, rear, side and ventral attachment points
- / Waist and leg support pads
- / Adjustable work positioning belt
- / Fold back side D rings
- / Fast fit buckles on leg straps

Accredited to: EN 361: 2002, EN 358: 2018 & EN 813: 2008

Web material: 45mm water repellent polyester

Weight: 2.1kg

Sizes\*: Standard & Large



BACK

## SAFETY HARNESS ACCESSORIES

### SAFETY HELMET

#### RG/HELMET/SPECIFIC COLOUR

Air games and design to wear: free spirit outside and tailored fit inside. Sprinty and sporty look for a clean and compact helmet. A new concept of the work helmet, developed for a new experience of comfort and safety never tried.

- / Tailored fit made of soft technical fabric COOLMAX® with SANITIZED® treatment
- / Easy turn dial adjusting system
- / Clips for lamp
- / Visor and Earmuff connection points

Accredited to: EN 397  
 External Shell: ABS  
 Ventilation: 8 holes  
 Weight: 340g  
 Size: 54-61cm  
 Colours: Black, White, Red and Yellow

COOLMAX® is a registered trademark developed and marketed by The Lycra Company (formerly "Dupont Textiles and Interiors", then "InVista")  
 SANITIZED® is a registered trademark of Sanitized AG



#### VISORS



**CLEAR**  
 RG/HELMET VISOR CLEAR



**SMOKE**  
 RG/HELMET VISOR SMOKE

#### EAR DEFENDER CONNECTORS

RG/HELMET EARD



### PARKING LOOP

#### RGK56



These parking loops are designed to fit onto the shoulder straps of the harness. Once fitted, the connector is connected directly to the loop for safe stowage. The loops also prevent lanyards from trailing on the floor and creating a trip hazard.

Material: Nylon

### PROJECT PLASTIC FREE PACKAGING

#### OUR OCEAN PLASTIC PLEDGE

Here at RIDGEGEAR we're making strides towards plastic free packaging for our product range. Our aim is to do our part and make better choices in our packing process. You'll notice our safety harness and safety lanyard ranges have already undergone the change from its former plastic packaging.



100%  
 SINGLE-USE  
 PLASTIC FREE



## eco HARNESSES

### DOING OUR BIT TO REDUCE OCEAN PLASTICS

Our ECO webbing is produced using ocean plastics, by making a recycled polyester. Recycled polyester doesn't just help reduce the plastics in our oceans, it also uses less energy when compared to virgin polyester. 33 - 55% less energy is used in the production of recycled polyester when compared with virgin yarn. The dye used is OEKO-Tex® which is certified free from harmful chemicals.

The difference between the two final products isn't noticeable. Safety wise ECO harnesses are just as strong, and have to go through the same strenuous tests as our standard harnesses. Our ECO harnesses also have the same 10 year lifespan as our standard range.





Join us on an adventure with our range of recreational harnesses and accessories.

From climbing walls to outdoor high rope courses we have the harnesses and equipment needed for the activity you desire.

Available in stylish, eye-catching and easily identifiable colours for quick size allocation.



**ADVENTURE HARNESS, 2POINT**

**RGH14 RR**

This version of our Adventure harness comes with the addition of nylon rope rings for improved comfort for users when partaking in recreational activities.

Each size is colour coded allowing for quick size allocation, ideal for busy periods. The harness is quick and easy to don, and once donned is designed to be difficult to remove unless assisted by an instructor.

- / Easy donning
- / Colour coded webbing
- / Front & rear attachment points
- / Tool loops
- / Lanyard connection direct to front chest ring. (Connector not include)

Accredited to: EN 12277:2015 Type A & B  
 Web material: 45mm water repellent polyester  
 Weight: 0.70kg X-Small  
 0.75kg Small  
 0.80kg Standard  
 Sizes\*: X-Small, Small & Standard



**10MM STEEL SCREWGATE D LINK**

**RGK20**



The RGK20 is an alternative connector to the conventional oval screw gate Karabiner. Its unique "D" shape allows for the perfect connection between 2 rings such as the central connection on EN 12277 harnesses and avoiding gate cross loading. Has many other applications where manual semi-permanent locking and D shape is preferred.

Accredited to: EN 12275:2013 & EN 362:2004  
 Material: Steel  
 Plating: Zinc  
 Gate opening: 10mm  
 External length: 86mm  
 Closure type: Screwgate  
 MBS: 45kN  
 Weight: 153g

**CLIMBING HARNESS**

**RGH12**

The RGH12 is a lightweight and comfortable solution for climbing and similar leisure activities. The step in design allows for speedy donning and adjustment for the user. Complete with central belay loop for attachment to safety ropes. The rear elastic loops ensure optimum comfort and are replaceable when subject to excessive wear.

- / Fully adjustable
- / Easy donning
- / Tool loops
- / Colour coded

Accredited to: EN 12277:2015 Type C  
 Web material: 45mm Polyester  
 Fittings: Steel  
 Weight: 0.5kg  
 Sizes\*: Small & Standard



**ADVENTURE HARNESS, 2PT**

**RGH14**

Our Adventure harness has been specifically designed to cater for a wide age and size variance. Due to the nature of outdoor activity centres, it is colour coded to ensure quick size allocation and is the perfect harness for any recreational use.

- / Easy donning
- / Colour coded webbing
- / Front & rear attachment points
- / Tool loops
- / Lanyard connection direct to front chest ring. (Connector not include)

Accredited to: EN 12277:2015 Type A & B  
 Web material: 45mm water repellent polyester  
 Weight: 0.80kg X-Small  
 0.85kg Small  
 0.90kg Standard  
 Sizes\*: X-Small, Small & Standard



\*Please refer to our harness size guide on Page 48.

## SAFETY LANYARDS - FALL ARREST

Connecting your harness to the anchor point is a crucial link that should never be compromised.

Our fall arrest range come with an energy absorbing unit that limits the force in the event of a fall. Designed to be used as part of a personal fall arrest system. Available in various lengths/styles with a range of connectors to choose from.



### ROPE LANYARD & SHOCK ABSORBER, SINGLE LEG

#### RGL2



The RGL2 lanyard uses kernmantle rope (which shows resistance to alkalis, oils and organic solvents) and is fitted with a standard shock absorber pack which absorbs any impulses in the event of a fall. This lanyard should be used when the operative is working from a static position, connected to a fixed anchor point.

Accredited to: EN 355:2002  
Lanyard Material: 11mm kernmantle nylon rope  
Fittings: RGK1\*  
Lengths: 1.3m & 1.8m  
Max Arrest Force: < 6kN

### SHORT SINGLE LEG WEBBING LANYARD & SHOCK ABSORBER

#### RGL1 MINI



Where short connection to the anchor point is required such as ladder climbing, the RGL1 Mini is the perfect choice of fall arrest lanyards. The short length reduces unnecessary slack and potential free fall distance. The integral absorber reduces the forces on the user and attachment points in the event of a fall.

Accredited to: EN 355:2002  
Lanyard Material: 26mm water repellent polyester  
Fittings: RGK1 & RGK11/SL\*  
Lengths: 0.6m (including connectors)  
Max Arrest Force: < 6kN

### KERNMANTLE ROPE LANYARD & SHOCK ABSORBER

#### RGL11



Fitted with a shock absorber pack, this lanyard is used extensively by major utility companies. It can be attached directly to a suitable anchorage point or choked around a pole or similar structure.

Accredited to: EN 355:2002  
Lanyard Material: 11mm kernmantle nylon rope  
Fittings: RGK15 and RGK19  
Length: 1.7m (including connectors)  
Max Arrest Force: < 6kN

### WEBBING LANYARD & SHOCK ABSORBER, SINGLE LEG

#### RGL1



This lanyard is an industry standard, and must be used in conjunction with a harness for anyone working at height. The lanyard comes fitted with a shock absorber pack and should be used when the operative is working from a static position, connected to a fixed anchor point.

Accredited to: EN 355:2002  
Lanyard Material: 26mm water repellent polyester  
Fittings: RGK1\*  
Lengths: 1.3m & 1.8m (including connectors)  
Max Arrest Force: < 6kN

### WEBBING LANYARD & SHOCK ABSORBER, TWIN LEG

#### RGL3



The RGL3 is a twin leg lanyard that is designed to allow movement between anchorage points by means of double clipping. This system is generally used for tower climbing, steel erecting, scaffolding and maintenance on open structures. The webbing provides greater strength, wear resistance and is treated with a water repellent coating to extend its life.

Accredited to: EN 355:2002  
Lanyard Material: 26mm water repellent polyester  
Fittings: RGK1\*  
Lengths: 1.3m & 1.8m (including connectors)  
Max Arrest Force: < 6kN

### WEBBING LANYARD & SHOCK ABSORBER, USERS UP TO 140KG, SINGLE LEG

#### RGL1 BIGGUY



Tested and approved for a user weight up to 150kg, this type of lanyard is usually the minimum equipment required for anyone working at height. We use 37kN water repellent polyester webbing to manufacture the lanyard which helps give the product exceptional strength and durability.

Accredited to: EN 355:2002  
Lanyard Material: 26mm water repellent polyester  
Fittings: RGK1 & RGK88  
Length: 1.4m (including connectors)  
Max Arrest Force: < 6kN up to fall factor 2

### WEBBING LANYARD & SHOCK ABSORBER, USERS UP TO 140KG, TWIN LEG

#### RGL3 BIGGUY



Tested and approved for a user weight up to 150kg, the RGL3 BigGuy is a twin leg lanyard that allows movement between anchorage points by means of double clipping and ensures continuous attachment. This system is generally used for tower climbing, steel erecting, scaffolding and maintenance on open structures.

Accredited to: EN 355:2002  
Lanyard Material: 26mm water repellent polyester  
Fittings: 2 x RGK88 and RGK1  
Length: 1.4m (including connectors)  
Max Arrest Force: < 6kN up to fall factor 2

\*Stated connectors supplied as standard. You have the option to choose from a selection of other EN362 fittings to suit your requirement. Please see page 23-26



## SAFETY LANYARDS - FALL ARREST

### WEBBING LANYARD & SHOCK ABSORBER, ELASTICATED SINGLE LEG

#### RGL6



A general-purpose lanyard used when the operative is working from a static position connected to a fixed anchor point. If movement between anchorages is required, a twin leg lanyard should be used (RGL9) to provide constant protection. The elastic in the lanyard reduces the amount of hanging slack, which helps to reduce trip hazards and entanglement.

Accredited to: EN 355:2002  
Lanyard Material: 36mm water repellent polyester  
Fittings: RGK1\*  
Lengths: 1.15m – 1.8m (including connectors)  
Max Arrest Force: < 6kN

### WEBBING LANYARD & SHOCK ABSORBER, ADJUSTABLE SINGLE LEG

#### RGL13



The RGL13 lanyard is an industry standard, but obtains the additional benefit of adjustability and superior flexibility. The lanyard length can be adjusted to suit the application so potential trip hazards can be avoided. This lanyard should be used when the operative is working from a static position and connected to a fixed anchor point.

Accredited to: EN 355:2002  
Lanyard Material: 26mm water repellent polyester  
Fittings: Steel adjuster & RGK1\*  
Length: 1.2m – 1.8m (including connectors)  
Max Arrest Force: < 6kN

### WEBBING LANYARD & SHOCK ABSORBER, ELASTICATED TWIN LEG

#### RGL9



Fitted with a shock absorber pack, the RGL9 features expanded elastic in the lanyard that reduces trip hazards and entanglement. As a twin leg lanyard, the extra leg allows movement between anchor points by means of double clipping. This system is generally used for tower climbing, steel erecting, scaffolding and maintenance to open structures.

Accredited to: EN 355:2002  
Lanyard Material: 36mm water repellent polyester  
Fittings: RGK1\*  
Lengths: 1.15m – 1.8m (including connectors)  
Max Arrest Force: < 6kN

### WEBBING LANYARD & SHOCK ABSORBER, ADJUSTABLE TWIN LEG

#### RGL16



The RGL16 is a twin leg fall arrest lanyard that allows movement between anchor points by means of double clipping. This system is fully adjustable and generally used for tower climbing, steel erecting, scaffolding and maintenance on open structures.

Accredited to: EN 355:2002  
Lanyard Material: 26mm water repellent polyester  
Fittings: 2 x steel adjusters & RGK1\*  
Length: 1.2m – 1.8m (including connectors)  
Max Arrest Force: < 6kN

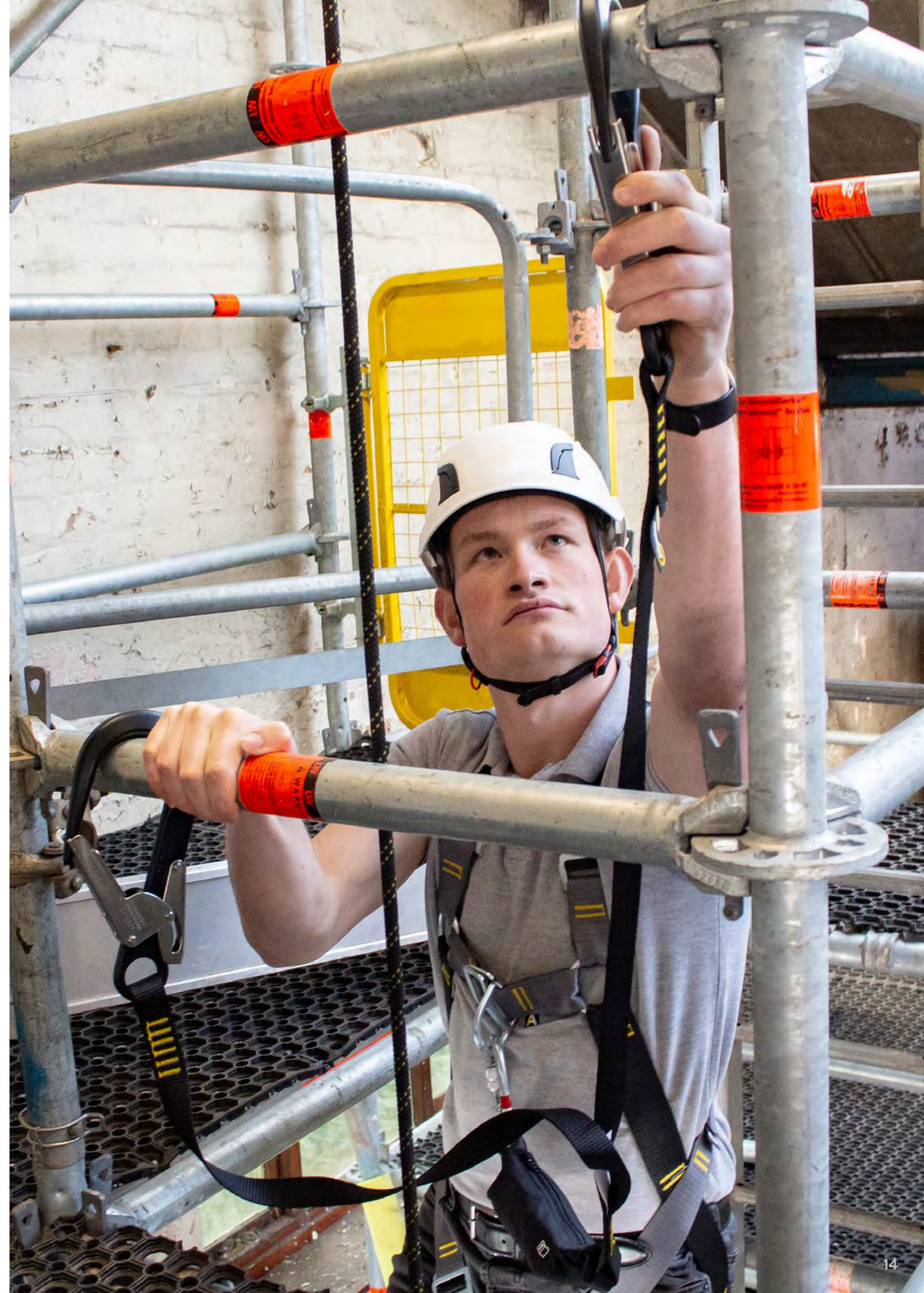

\*Stated connectors supplied as standard. You have the option to choose from a selection of other EN362 fittings to suit your requirement. Please see page 23-26

## SAFETY LANYARDS - FALL ARREST

### WEBBING LANYARD, KINETIC® SINGLE LEG

RGL20



The RGL20 is a Kinetic® fall arrest lanyard – a fully integrated system. A new innovation in safety lanyards, featuring webbing that will stretch under a constant controlled force to reduce the impact on the wearer. The RGL20 also incorporates a rip stitch indicator that automatically deploys in the event of a fall. This lanyard should be used when the operative is working from a static position, connected to a fixed anchor point.

Accredited to: EN 355:2002  
Lanyard Material: 40mm water repellent polyester  
Fittings: Supplied without connectors  
Lengths: 1.3m & 1.8m  
Max Arrest Force: < 6kN

### WEBBING LANYARD & SHOCK ABSORBER, TIE BACK SINGLE LEG

RGL30



The RGL30 has been designed to loop around larger structures / anchor points, or for lanyard shortening. Inner loops are colour coded for ease of connection and visibility.

Accredited to: EN 355:2002  
Lanyard Material: 26mm water repellent polyester 37kN  
Fittings: RGK2P\*  
Length: 1.8m (including connectors)  
Max Arrest Force: < 6kN

### SELF RETRACTING LANYARD, TWIN LEG CHASER

RGL28



The twin leg Chaser is a self-retracting, fully adjustable lanyard fitted with a shock absorber pack, containing retracting lines that lock at the onset of a fall. The reduced trip hazard and ultra-compact design make this unit ideal for tight work and tasks where a shorter arc of mobility is required.

Accredited to: EN 360:2002  
Lanyard Material: 15mm high strength UHMWPE  
Fittings: 2 x RGK11/SL & RGK2P\*  
Lengths: 0.80m – 2m (including connectors)  
Max Arrest Force: < 6kN

### WEBBING LANYARD & SHOCK ABSORBER, TIE BACK TWIN LEG

RGL29



Having the same benefits as the RGL30, the RGL29 is a twin leg version to provide constant attachment and added safety.

Accredited to: EN 355:2002  
Lanyard Material: 26mm water repellent polyester 37kN  
Fittings: RGK2P\*  
Length: 1.8m (including connectors)  
Max Arrest Force: < 6kN

### SHOCK ABSORBING LANYARD, CLIC-IT® TWIN LEG

RGL60



The CLiC-iT® RGL60 is a revolutionary lanyard with interacting connectors and provides the user with continuous protection as one cannot be opened without the other being closed. It is suitable for Scaffolding, Pylons / Angle Beams, Anchor Points, Cables, Straps and Ropes, Ladders / Masts.

Accredited to: EN 355:2002  
Lanyard Material: Dyneema® / Spectra® straps, Elastic webbing, Etched aluminium casing, Copper-aluminium mechanism, Stainless steel  
Fittings: Interacting connectors  
Lengths: 1.43m (at rest), 1.88m (flexed), 1.44m (range)  
Max Arrest Force: < 6kN

## A GUIDE TO SAFE FALL CLEARANCES FOR RIDGEGEAR SHOCK ABSORBER SAFETY LANYARDS

Consideration should be given to the first obstruction and not necessarily the lower level.

These figures are based on worst case scenarios, anchored at foot level.

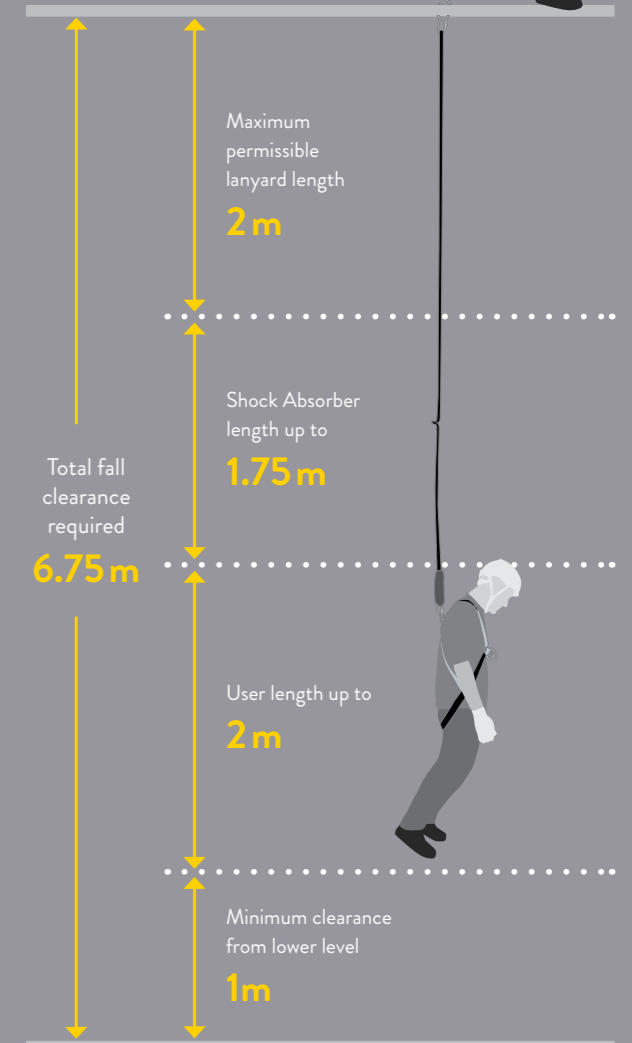

Dyneema® is a registered trademark of DSM Intellectual Property.

Spectra® is a trademark of Honeywell International Inc.

CLiC-iT® technology is subjected to several patents in France, Europe and the United-States and is registered as an international trademark by SARL DEHONDT.

\*Stated connectors supplied as standard. You have the option to choose from a selection of other EN362 fittings to suit your requirement. Please see page 23-26

## SAFETY LANYARDS - WORK RESTRAINT

Our work restraint lanyards are designed to hold the user in restraint. These lanyards, when used correctly, make the risk of falling almost impossible by preventing the user reaching an area where this may occur. If there is any risk of a fall then a fall arrest product should be used.

Available in various lengths/styles with a range of connectors to choose from.



### WEBBING RESTRAINT LANYARD, SINGLE LEG

#### RGL5



The strong webbing provides greater strength, wear and shear resistance and is treated with a water repellent coating to extend its life. To be used for restraint purposes only, if a fall is likely, then a fall arrest product should be used.

Accredited to: EN 354:2010  
Lanyard Material: 26mm water repellent polyester  
Fittings: Supplied without connectors  
Lengths: 1m, 1.3m & 1.8m (including connectors)

### SINGLE LEG ROPE RESTRAINT LANYARD

#### RGL5R



The 11mm kernmantle rope provides greater strength and superior wear resistance compared to webbing. To be used for restraint purposes only. If a fall is likely, then a fall arrest product should be used.

Accredited to: EN 354:2010  
Lanyard Material: 11mm kernmantle nylon rope  
Fittings: Supplied without connectors  
Lengths: 1m, 1.3m & 1.8m (including connectors)

### WEBBING RESTRAINT LANYARD, TWIN LEG

#### RGL14



The webbing used in the production of the RGL14 provides greater strength compared to other systems. We recommend that the user is working in a fixed position and connected to a suitable anchor point. Movement between anchorages can be achieved by means of double clipping.

Accredited to: EN 354:2010  
Lanyard material: 26mm water repellent polyester  
Fittings: Supplied without connectors  
Lengths: 1.3m & 1.8m (including connectors)

### WEBBING RESTRAINT LANYARD, ADJUSTABLE SINGLE LEG

#### RGL12



The RGL12 is a fully adjustable restraint lanyard, therefore ensures that the correct length can be selected. The various lengths are available to act as a leash for an operative working at height. To be used for restraint purposes only, if a fall is likely, then a fall arrest product should be used.

Accredited to: EN 354:2010  
Lanyard material: 26mm water repellent polyester  
Fittings: Steel adjuster only.  
Lengths: 0.63m - 1m (including connectors)  
0.89m - 1.5m (including connectors)  
1.13m - 2m (including connectors)

### WEBBING RESTRAINT LANYARD, LADDER

#### RGL31



This short lanyard has been specifically designed for ladder restraint. The two attachment points can be used to adjust the length between yourself and the ladder. It can only be used for work-restraint and should never be used to extend another fall-arrest product.

Accredited to: EN 354:2010  
Lanyard Material: 26mm water repellent polyester 37kN  
Fittings: RGK11/SL & RGK1\*  
Length: 0.56m, can be reduced to 0.44m (including connectors)

### WEBBING RESTRAINT LANYARD, ADJUSTABLE TWIN LEG

#### RGL19



The RGL19 is a twin leg adjustable restraint lanyard and should be used for restraint purposes only. If there is any risk of a fall then a fall arrest product should be used.

Accredited to: EN 354:2010  
Lanyard material: 26mm water repellent polyester  
Fittings: 2 x steel adjusters.  
Length: 1.2m - 1.8m (including connectors)

### WEBBING EXTENSION STROP

#### RGL4



The RGL4 is used as an extension strop fitted to the rear D ring of a full body harness. It features a sewn eye on the free end and allows the operative to independently connect themselves to a fall arrest block.

Accredited to: EN 354:2010  
Lanyard Material: 26mm water repellent polyester  
Fittings: RGK12\*  
Length: 0.45m (including connectors)

\*Stated connectors supplied as standard. You have the option to choose from a selection of other EN362 fittings to suit your requirement. Please see page 23-26

## KITS

Our range of height safety kits are designed for multiple applications.

Each kit contains a RGH2 harness, fall arrest or work restraint lanyard, and all the connectors you need to ensure safe working conditions at all times.

We have a range of storage solutions (see page 37) suitable to store your kit, please ask if required.



### THE BASIC KIT

#### RGHK1

The basic kit should be used when connected to a fixed anchor point and working from a static position. Recommended use when working near a close edge or on a fragile surface.

This kit contains;

- / RGH2 Front and rear D harness *SEE PAGE 2*
- / RGL1 1.8m single leg webbing lanyard & shock absorber *SEE PAGE 12*
- 2 x attached RGK1 karabiners *SEE PAGE 24*

Accredited to: EN 361:2002 & EN 355:2002



### THE SCAFFOLDER'S KIT

#### RGHK2

A complete safety kit designed for those working at height, scaffolding and other steel structures.

This kit contains;

- / RGH2 Front and rear D harness
- / RGL1 1.8m single leg webbing lanyard & shock absorber *SEE PAGE 12*
- 1 x attached RGK1 karabiner *SEE PAGE 24*
- 1 x attached RGK11 scaffold hook *SEE PAGE 26*

Accredited to: EN 361:2002 & EN 355:2002



### THE TWIN LEG SCAFFOLDER'S KIT

#### RGHK4

Designed to allow movement between anchor points, this kit is generally used for tower climbing, steel erecting, scaffolding and maintenance on open structures.

This kit contains;

- / RGH2 Front and rear D harness
- / RGL3 1.8m twin leg webbing lanyard & shock absorber *SEE PAGE 12*
- 1 x attached RGK1 karabiner *SEE PAGE 24*
- 2 x attached RGK11 scaffold hooks *SEE PAGE 26*

Accredited to: EN 361:2002 & EN 355:2002



### THE MEWP RESTRAINT KIT

#### RGHK5 MEWP

Approved to IPAF technical guidance notes TGNH1/05/05, this kit gives maximum protection against vertical expulsion when working in MEWPs and cherry pickers.

This kit contains;

- / RGH2 Front and rear D harness
- / RGL12 1.5m adjustable restraint lanyard *SEE PAGE 18*
- 2 x attached RGK1 karabiners *SEE PAGE 24*

Accredited to: EN 361:2002 & EN 354:2010



### THE BIG GUY KIT

#### RGHK11 BIGGUY

Tested and approved for a user weight up to 150kg, this kit must only be used when working from a static position at height. Recommended for use near a close edge or fragile surface.

This kit contains;

- / RGH2 Big Guy Front and rear D harness
- / RGL1 Big Guy 1.4m single leg webbing lanyard & shock absorber *SEE PAGE 12*
- 1 x attached RGK1 karabiner *SEE PAGE 24*
- 1 x attached RGK88 scaffold hook *SEE PAGE 26*

Accredited to: EN 361:2002 & EN 355:2002  
Tested and approved for a user weight up to 140kg



### THE TWIN LEG BIG GUY KIT

#### RGHK12 BIGGUY

Tested and approved for a user weight up to 150kg, this kit allows movement between anchor points and is generally used for tower climbing, steel erecting, scaffolding and maintenance on open structures.

This kit contains;

- / RGH2 Big Guy Front and rear D harness
- / RGL3 Big Guy 1.4m twin leg webbing lanyard & shock absorber *SEE PAGE 12*
- 1 x attached RGK1 karabiner *SEE PAGE 24*
- 2 x attached RGK88 scaffold hooks *SEE PAGE 26*

Accredited to: EN 361:2002 & EN 355:2002  
Tested and approved for a user weight up to 140kg



\*Please refer to our harness size guide on Page 48.

## WORK POSITIONING & ANCHORAGE

Our range of work positioning and anchorage equipment is designed to make your tasks as easy as possible. Any difficult circumstances encountered whilst working at height should be able to be overcome with this equipment.

If you need any advice then please get in touch.



### WIRE POLE STRAP

#### RGP4



The RGP4 is a multi-purpose, fully-adjustable work positioning device and is designed to be clipped to the side D rings of a harness or work-positioning belt but it can also be used independently. To be used for work positioning or restraint purposes only.

Accredited to: EN 358:2018  
 Material: 6mm galvanised wire covered with poly rope for protection  
 Fittings: High tensile steel alloy  
 Length: 6m  
 Features: Fully adjustable  
 Max. User Weight: 140kg

### SINGLE D RESTRAINT BELT

#### RGBE



The RGBE restraint belt is fitted with one D ring attachment mounted at the rear, perfect for work being carried out on flat roofs to prevent the user from reaching the edge. The back pad provides lumbar support and comfort whilst working.

/ 1 x rear D ring  
 / Padded back support

Accredited to: EN 358:2018  
 Material: 45mm water-repellent polyester  
 Fittings: High tensile steel alloy  
 Weight: 0.62kg

### TWIN D WORK POSITIONING BELT

#### RGB2



The RGB2 work positioning / restraint belt is fitted with a buckle and two side-mounted D rings for ease of attachment and a back pad that provides lumbar support and comfort. To be used with any restraint lanyard or pole strap.

/ 2 x side D rings  
 / Padded back support

Accredited to: EN 358:2018  
 Material: 45mm water-repellent polyester  
 Fittings: High tensile steel alloy  
 Weight: 0.7kg

### HORIZONTAL / TEMPORARY LIFELINE KIT

#### RGHL1



The RGHL1 is a simple to install horizontal webbing safety line, incorporating a ratchet tensioner. It can be used in conjunction with fixed length or adjustable restraint and fall arrest lanyard and allows horizontal movement. This kit contains;

/ Horizontal webbing safety line with ratchet tensioner  
 / 2 x RGK26 anchor slings SEE PAGE 29  
 / 2 x RGK3 karabiners SEE PAGE 17  
 / Carry bag

Accredited to: EN 795: 2012, Type C  
 Material: 35mm polyester line  
 Lengths: 10m & 20m

### WORK POSITIONING FINCH

#### RGPI FINCH



The RGPI Finch can be used for work positioning by clipping onto both side D rings located on a work positioning belt and wrapping around a suitable structure, or as an adjustable restraint lanyard to prevent the user from entering the risk of a fall situation. The smooth cam action allows the user to move freely and adjust with ease. When using in work positioning the RGPI Finch has an additional wear sleeve to protect the rope from abrasion.

Accredited to: EN 358:2018  
 Lanyard Material: 11mm kernmantle nylon rope  
 Fittings: Double action snap hook, screwgate karabiner & adjuster  
 Lengths: 2m, 5m & 10m  
 Weight: 2m - 0.62kg, 5m - 0.87kg, 10m - 1.29kg  
 Max. User Weight: 140kg

### UTILITY MULTI-PURPOSE POLE STRAP

#### RGPI1



The RGPI1 has been specifically designed with a controlled release adjuster buckle to ensure safe operation and adjustment. As with the other pole straps, it should be clipped to the side D rings of a harness or work positioning belt. It can also be used individually if required. The twisted snap hook and two part triangle / karabiner ensures flat surface contact with pole whilst working.

Accredited to: EN 358:2018  
 Material: 43mm polyester webbing 3000kg 75mm webbing abrasion pad  
 Fittings: RGK45 & RGK15  
 Length: 1.9m  
 Features: Fully approved and used extensively by major utility companies  
 Max. User Weight: 140kg

### ANCHORAGE SLING

#### RGK26



The RGK26 is a quick and convenient way to attach fall arrest equipment to objects too large for a standard scaffold hook attachment method. It can also be used for attaching rescue equipment and secondary back-up systems.

/ Lightweight attachment supplied in various lengths

Accredited to: EN795: 2012, Type B  
 Material: Polyester cover and core  
 System strength: 70kN  
 Length/Weight: 1m = 250g, 2m = 450g, 3m = 600g

### SLINGKY ANCHORAGE SLING

#### RGK26DC



Made from our MT-X webbing using UHMWPE yarn produced by sister company MARLING LEEK. Extensively tested to be ultra-resistant to cuts and abrasion. Offers great breaking strength-to-weight ratio. Resistant to UV degradation and chemical attack. Features an integral outer wear sleeve offering further protection and durability.

/ Outer protective wear sleeve

Accredited to: EN795: 2012, Type B  
 Material: MT-X webbing (UHMWPE yarn) 14mm  
 System strength: > 22kN  
 Length/Weight: 1m = 70g, 2m = 150g

## CONNECTORS - STEEL

Our range of connectors is the most comprehensive available. All of our devices are of the highest quality and offer every user the complete safety solution. An important, but often overlooked piece of equipment.

Our steel connectors are durable and have various closure types with different levels of safety.



### 10MM STEEL SCREWGATE DELTA LINK

#### RGK12



The RGK12 provides a semi-permanent connection to fall arrest equipment. This item is normally used with a shock pack or lanyard, but has many other applications in the rope access and leisure industries. The screwgate closure on this device means that the user must manually lock the RGK12 keeper after fitting.

Accredited to: EN 362:2004  
Material: Steel  
Plating: Zinc  
Gate opening: 10mm  
External length: 73mm  
Closure type: Screwgate  
MBS: 27kN  
Weight: 87g

### 10MM STEEL SCREWGATE D LINK

#### RGK20



The RGK20 is an alternative connector to the conventional oval screw gate Karabiner. Its unique "D" shape allows for the perfect connection between 2 rings such as the central connection on EN12275 harnesses and avoiding gate cross loading. Has many other applications where manual semi-permanent locking and D shape is preferred.

Accredited to: EN 12275:2013 & EN 362:2004  
Material: Steel  
Plating: Zinc  
Gate opening: 10mm  
External length: 86mm  
Closure type: Screwgate  
MBS: 45kN  
Weight: 153g

### 17MM STEEL SCREWGATE KARABINER

#### RGK1



The RGK1 is our most popular karabiner. The screwgate closure on this device has to be locked manually.

Accredited to: EN 362:2004  
Material: Steel  
Plating: Zinc  
Gate opening: 17mm  
External length: 107mm  
Closure type: Screwgate  
MBS: 23kN  
Weight: 160g

### 17MM STEEL TWISTLOCK KARABINER

#### RGK2



The RGK2 is an extremely safe karabiner as it locks automatically and also available with a captive pin (RGK2P).

Accredited to: EN 362:2004  
Material: Steel  
Plating: Zinc  
Gate opening: 17mm  
External length: 107mm  
Closure type: Twistlock  
MBS: 25kN

### 17MM STEEL TWISTLOCK KARABINER WITH CAPTIVE PIN

#### RGK2P



Like the RGK2, the RGK2P features the same attributes but has the extra feature of a captive pin to allow permanent fixture to the lanyard.

Accredited to: EN 362:2004  
Material: Steel  
Plating: Zinc  
Gate opening: 17mm  
External length: 107mm  
Closure type: Twistlock  
MBS: 25kN

### 24MM STEEL TWISTLOCK KARABINER

#### RGK3



This robust karabiner is primarily fitted to the ends of fall arrest lanyards and horizontal temporary anchor lines. The twist lock closure makes this karabiner very safe to use as it locks automatically when clipped to an anchorage point. The gate is secure and strong as required by ANSI standards.

Accredited to: EN 362:2004 & ANSI Z359.12  
Material: Steel  
Plating: Zinc  
Gate opening: 24mm  
External length: 119mm  
Closure type: Twistlock  
MBS: 50kN  
Weight: 300g

### 18MM STEEL TRIPLE ACTION KARABINER WITH CAPTIVE EYE

#### RGK18



The RGK18 is a particularly strong and safe karabiner that benefits from a forged profile with a captive eye. It can be fitted to most lanyard types where additional safety is preferred. The captive eye ensures permanent attachment to the lanyard and the gate is extremely strong as required by ANSI standards.

Accredited to: EN 362:2004 & ANSI Z359.12  
Material: Steel  
Plating: Zinc  
Gate opening: 18mm  
External length: 135mm  
Closure type: Triple action  
MBS: 45kN  
Weight: 300g  
Eye diameter: 22mm

### 23MM STEEL TRIPLE ACTION KARABINER WITH CAPTIVE EYE

#### RGK19



Similar to the RGK18, this strong and safe karabiner benefits from a forged profile with captive eye and wider gate opening. It can be fitted to most lanyard types where additional safety is preferred. The captive eye ensures permanent attachment to the lanyard.

Accredited to: EN 362:2004  
Material: Steel  
Plating: Zinc  
Gate opening: 23mm  
External length: 131mm  
Closure type: Triple action  
MBS: 45kN  
Weight: 260g  
Eye diameter: 22mm

### 19MM STEEL DOUBLE ACTION SNAP HOOK

#### RGK10



The RGK10 is an alternative option to a twistlock karabiner. The double action and self-closing gate opening means that this item is normally used for clipping directly into a D ring on a harness. It features a forged profile with a captive eye for permanent fixture to the lanyard.

Accredited to: EN 362:2004  
Material: Steel  
Plating: Zinc  
Gate opening: 19mm  
External length: 144mm  
Closure type: Double action  
MBS: 23kN  
Weight: 275g  
Eye diameter: 25mm

### 21MM STEEL DOUBLE ACTION SNAP HOOK WITH CAPTIVE EYE

#### RGK45



The RGK45 has a double-action automatic lock feature and the benefit of a captive eye for permanent attachment to the lanyard. It also incorporates a swivel function which eliminates twisting.

Accredited to: EN 362:2004  
Material: Steel  
Plating: Zinc  
Gate opening: 21mm  
External length: 173mm  
Closure type: Double action  
MBS: 23kN  
Weight: 345g

### 56MM STEEL TWISTLOCK SCAFFOLD KARABINER

#### RGK5



With a large gate opening making it ideal for use in industrial areas, it can be connected directly to steelwork/scaffolding. Often fitted to double lanyards for climbing masts and steel structures, it is fitted with a twistlock closure which locks automatically and has the option of fitting a captive pin for permanent fixture to the lanyard.

Accredited to: EN 362:2004  
Material: Steel  
Plating: Zinc  
Gate opening: 56mm  
External length: 229mm  
Closure type: Twistlock  
MBS: 30kN  
Weight: 750g



Optional Captive Pin

## CONNECTORS - ALUMINIUM

When weight is of high importance, choose aluminium. Low weight alternatives to our steel connector range without compromising strength.

Available in a variety of closure types.

### 19MM SCREWGATE ALUMINIUM KARABINER

RGK1/A



The RGK1/A is a lightweight alternative to the RGK1. The screwgate closure on this device means that the user must manually lock the RGK1/A keeper after fitting. RGK1/As are the basic universal karabiner used within the climbing industry where weight is important. Each karabiner is supplied with a unique serial number for complete traceability and inspection control.

Accredited to: EN 362:2004 & EN 12275:2013  
Material: Aluminium  
Plating: Anodised  
Gate opening: 19mm  
External length: 111mm  
Closure type: Screwgate  
MBS: 24kN  
Weight: 80g

### 19MM TRIPLE ACTION ALUMINIUM KARABINER

RGK1/AT



The RGK1/AT is a triple action alternative to the RGK1/A. The triple action closure on this device means that the keeper automatically locks after fitting. RGK1/AT is the basic universal karabiner used within the climbing industry where weight is important, with extra safety closure. Each karabiner is supplied with a unique serial number for complete traceability and inspection control.

Accredited to: EN 362:2004 & EN 12275:2013  
Material: Aluminium  
Plating: Anodised  
Gate opening: 19mm  
External length: 111mm  
Closure type: Triple action  
MBS: 24kN  
Weight: 86g

### 60MM ALUMINIUM DOUBLE ACTION SCAFFOLD HOOK WITH CAPTIVE EYE

RGK11



The aluminium RGK11 features a large gate opening and a captive eye for permanent fixture to the lanyard. It is typically used with fall arrest lanyards for quick clipping onto scaffolding or steel structures. The double action snap closure cannot be accidentally opened but allows for quick operation. Often used on twin lanyards.

Accredited to: EN 362:2004  
Material: Aluminium  
Plating: Anodised  
Gate opening: 60mm  
External length: 248mm  
Closure type: Double action  
MBS: 23kN  
Weight: 480g  
Eye diameter: 30mm

### 55MM SUPER LIGHT ALUMINIUM DOUBLE ACTION SCAFFOLD HOOK WITH CAPTIVE EYE

RGK11/SL



The RGK11 Super Light karabiner is the perfect connector for fall arrest lanyards as it is lightweight, easy to use and allows the user to quickly clip themselves onto scaffold or steel structures. It is very similar to the RGK11, but this version is considerably lighter (almost half the weight). The double action snap closure on this device means that it cannot be accidentally opened, but allows a quick and safe operation.

Accredited to: EN 362:2004  
Material: Aluminium  
Plating: Anodised  
Gate opening: 55mm  
External length: 218mm  
Closure type: Double action  
MBS: 25kN  
Weight: 264g

### 22MM ALUMINIUM TWISTLOCK KARABINER

RGK4



The RGK4 is a lightweight karabiner with a twistlock and automatic closure. This item can be fitted to fall arrest lanyards, and used with belay devices and pulleys in the rope access and rescue industries.

Accredited to: EN 362:2004  
Material: Aluminium  
Plating: Anodised  
Gate opening: 22mm  
External length: 112mm  
Closure type: Twistlock  
MBS: 24kN  
Weight: 83g

### 22MM ALUMINIUM TRIPLE ACTION KARABINER WITH SWIVEL HOOK & CAPTIVE EYE

RGK44



The RGK44 has the added feature of a triple action closure and a fall indicator, this karabiner is lightweight and includes a captive eye for permanent attachment to the lanyard. It also incorporates a swivel function to eliminate twisting, therefore it is beneficial when connected to self-restraint equipment or self-retracting lanyards.

Accredited to: EN 362:2004  
Material: Aluminium  
Plating: Anodised  
Gate opening: 22mm  
External length: 180mm  
Closure type: Triple action  
MBS: 30kN  
Weight: 177g



Fall Indicator

### 54MM ALUMINIUM TWISTLOCK SCAFFOLD KARABINER

RGK6



A lightweight karabiner with a large gate opening allowing attachment to scaffolding and steel structures. Fitted with a twistlock closure which locks automatically, it can be used in conjunction with fall arrest lanyards, ropes and rope grab systems to provide vertical protection. Used throughout as part of a protection system with the option of fitting a captive pin, allowing permanent fixture to the lanyard.

Accredited to: EN 362:2004  
Material: Aluminium  
Plating: Anodised  
Gate opening: 54mm  
External length: 240mm  
Closure type: Twistlock  
MBS: 23kN  
Weight: 351g



Optional Captive Pin

### 20MM STEEL DOUBLE ACTION SNAP HOOK WITH CAPTIVE EYE

RGK50



The inner flat profile makes the RGK50 the most suitable and safe connector for attachment to step bolts. The 18mm gate opening allows for ideal connection to 16mm diameter step bolts. Also the increased gate strength is a feature required by ANSI standards. Can also be used as an alternative to conventional connectors.

Accredited to: EN 362:2004  
Material: Aluminium body, steel gate  
Plating: Anodized, Zinc  
Gate opening: 20mm  
External length: 185mm  
Closure type: Double action  
MBS: 23kN  
Weight: 414g  
Eye diameter: 30mm

### 62MM ALUMINIUM DOUBLE ACTION SCAFFOLD HOOK WITH CAPTIVE EYE

RGK88



The heavy duty RGK88 has a large gate opening and captive eye, and is usually fitted to fall arrest lanyards for quick clipping onto scaffold or steel structures. The double action snap closure means that it cannot be accidentally opened, but allows a quick operation. Often used on twin leg lanyards and slightly heavier than the RGK11 due to increased gate strength as required by ANSI standards.

Accredited to: EN 362:2004 & ANSI Z359.12  
Material: Aluminium  
Plating: Anodised  
Gate opening: 62mm  
External length: 248mm  
Closure type: Double action  
MBS: 23kN  
Weight: 640g  
Eye diameter: 30mm



## ROPES AND GRABS

Our popular and versatile kernmantle rope is strong, reliable and highly abrasion resistant making it suitable for all kinds of rope access, fall arrest and work positioning.

- / High grade polyamide
- / Twisted cores
- / Ultra-lightweight at high minimum breaking load
- / High-twist mantle braid
- / Dirt resistant
- / Excellent grip/strength
- / High abrasion protection

It can be used in conjunction with any of our rope grabs

### 10.5MM KERNMANTLE ROPE

#### RGRO10.5



This static rope is highly abrasion resistant, very low stretch, maximum strength, extremely durable and has a long service life. This rope is suitable for many kinds of rope access and work positioning. It can also be used for rescue work, guide work, expeditions and caving. Can be used in conjunction with RGA31.

Accredited to: EN 1891A:1998  
 Material: Polyamide outer sheath and twisted inner core  
 Length: 700m - Loose in Box  
 Weight: 72g/m  
 Breaking strength: 32kN  
 Max arrest force: < 6kN (when used with compatible device)

### 11MM KERNMANTLE ROPE

#### RGRO11



The RGRO11 provides vertical, or near vertical fall protection and is fitted with a single spliced eye and heat-shrink cover. It is a static rope that is highly abrasion resistant, low stretch, maximum strength, extremely durable and has a long service life. This rope is suitable for all kinds of fall arrest, work positioning and rope access. It can also be used for rescue work, guide work, expeditions and caving.

Accredited to: EN 1891A:1998  
 Material: Polyamide outer sheath & twisted inner core  
 Lengths: Standard lengths are 10m, 20m, 30m - or by the metre (plain ends)  
 Weight: 75g/m  
 Breaking strength: 32kN  
 Max arrest force: < 6kN (when used with RGA device conforming to EN 353-2)

### KERNMANTLE ROPE GRAB

#### RGA12



The RGA12 is designed to provide vertical fall protection to operatives ascending/descending a ladder or structure. In use, the RGA12 should be connected directly to the chest attachment of a compatible harness via a karabiner. This ensures that the operative is held close to the structure and in the event of a slip, the fall distance and loading on the top anchor and user is minimal.

- / Safety lock
- / Use with 11m kernmantle rope only (RGRO11)
- / Lightweight

Accredited to: EN 353-2:2002  
 Material: Stainless steel body with alloy cam  
 Weight: 0.8kg  
 Max arrest force: < 6kN

### ISC ROPE GRAB

#### RGA31



The RGA31 rope grab is a lightweight compact unit for use on vertical safety lines. It has a pip pin axle, allowing the rope grab to be easily fitted or removed from the working rope line at any time, without the need for the user to detach from their harness.

- / Pip pin allowing quick attachment of rope.
- / Suitable for kernmantle rope diameter 10.5 - 13mm.

Accredited to: EN 353-2:2002  
 Material: Aluminium  
 Weight: 180g  
 Max arrest force: N/A

### GRABBER ROPE GRAB

#### RGA14



The RGA14 is designed to provide vertical fall protection to operatives ascending/descending a ladder or structure. It is also used in the rope access industry, as a protection device on the safety rope. When used for vertical progression, it is recommended that slight tension be placed on the bottom of the rope to aid movement. It can be permanently attached to the rope but is also removable.

- / Manual lock-off
- / Use with any rope diameter 10.5 - 12.7mm
- / Lightweight

Accredited to: EN 353-2:2002  
 Material: Aluminium alloy  
 Weight: 0.2kg  
 Max arrest force: < 6kN



## FALL ARREST BLOCKS

When working at height, fall arrest systems are an effective way of intercepting a fall and at RIDGEGEAR we offer safe, streamlined and ergonomic blocks you can rely on.

Our original fall arrest blocks are made to be robust, reliable and predominately used in industrial environments.



### FALL ARREST BLOCK - 6M

#### RGA26

The RGA26 is a multi-purpose fall arrest block, with a working length of 6m. It allows uninhibited movement during normal working activity and features a carrying handle that is part of the cast alloy housing which can be connected to the anchorage point using soft slings or a karabiner. The RGA26 is used throughout the industry to provide semi-permanent protection in work areas. Operatives can self-connect to the block, using an extension strop (RGL4) to ease the task.

Accredited to: EN 360:2002

Connectors: Double action high tensile steel swivel karabiner

Weight: 5.2kg

Max fall arrest load: < 6kN

Line material: 5mm galvanised wire

Case material: Alloy

Max. user weight: 140kg



### FALL ARREST BLOCK - 10M

#### RGA2

The RGA2 is a popular multi-purpose fall arrest block, which allows uninhibited movement during normal working activity. The carrying handle is part of the cast alloy housing and can be connected to the anchorage point using soft slings or a karabiner. The RGA2 provides semi-permanent protection, particularly in industrial work areas. For self-connecting the block, it is recommended that the operative uses an extension strop (RGL4) in order to ease the task.

Accredited to: EN 360:2002

Connectors: Double action high tensile steel swivel karabiner

Weight: 6.5kg

Max fall arrest load: < 6kN

Line material: 5mm galvanised wire

Case material: Alloy

Max. user weight: 140kg



### FALL ARREST BLOCK - 15M

#### RGA3

The RGA3 is a robust fall arrest block with a long working length and of strong, industrial construction. The RGA3 is predominantly popular with the offshore and oil industries but can be used in most industrial scenarios to provide protection in work areas with overhead anchorage points. The carrying handle is part of the cast alloy housing and can be connected to the anchorage point using soft slings or a karabiner.

Accredited to: EN 360:2002

Connectors: Double action high tensile steel swivel karabiner

Weight: 10.5kg

Max fall arrest load: < 6kN

Line material: 5mm galvanised wire

Case material: Alloy

Max. user weight: 140kg



### FALL ARREST BLOCK - 2.5M (WEBBING)

#### RGA1

The RGA1 is a retractable mini web block ideal for personal issue to operatives working at height. The unit is designed to be connected to a suitable anchor point and the swivel end to the harness. The RGA1 has an almost instant lock off in the event of a fall, and recoils into the drum when slack is introduced into the lanyard. The reduced trip hazard and compact design make this unit ideal for tight work and tasks where a shorter arc of mobility is required. The addition of a swivel hook avoids twists to the webbing.

/ Internal braking system

Accredited to: EN 360:2002

Connectors: RGK1 & RGK44

Weight: 1.4kg

Max fall arrest load: < 6kN

Line material: 47mm polyester webbing

Case material: Steel with rubber protective cover

Max. user weight: 140kg



#### FALL INDICATOR

All our Fall Arrest Blocks feature one of these fall indicators to easily identify that a fall has occurred.

### FALL ARREST BLOCK WITH RECOVERY WINCH - 15M

#### RGA4

The RGA4 is a three way retrieval block fitted with an up/down winch mechanism and the standard fall arrest capability. This unit can be used as a standard fall arrest block, but in the event of a fall the operative can be winched up or down to safety almost immediately. The winch function is for use only as a recovery provision and not for access/egress. This arrangement must be backed up with an independent separate fall arrest system, and a rescue provision that is also separate to the winch. The RGA4 is supplied with galvanised wire cable.

Accredited to: EN 360:2002

Connectors: Double action high tensile steel swivel karabiner

Weight: 11.4kg

Max fall arrest load: < 6kN

Line material: 5mm galvanised wire

Case material: Alloy

Max. user weight: 140kg



### FALL ARREST BLOCK WITH RECOVERY WINCH & STEADYING HANDLE - 15M

#### RGA4H

A three way retrieval block with the added benefit of a steadying handle, fitted with an up/down winch mechanism and the standard fall arrest capability. In the event of a fall, the operative can be winched up or down to safety. The RGA4H can raise the operative to a safe area if the area below is unsuitable. The man-riding winch function is for retrieval only - NOT for access/egress. This must be backed up with a separate fall arrest system, and a rescue provision separate to this device.

/ Steadying handle

Accredited to: EN 360:2002

Connectors: Double action high tensile steel swivel karabiner

Weight: 11.6kg

Max fall arrest load: < 6kN

Line material: 5mm galvanised wire

Case material: Alloy

Max. user weight: 140kg



# DEFENDER

The defender range offers a lightweight, more compact alternative to traditional fall arrest blocks. With all the same benefits as our other fall arrest blocks, but with a sleeker design and a top swivel to help with connection.



## DEFENDER FALL ARREST BLOCK - 6M

### RGA6 DEF

Designed to intercept any fall, the 6 metre Defender block is the perfect solution for fall arrest situations. Its compact yet lightweight proportions makes this block an exclusive choice in the current market.

- Accredited to: EN 360:2002
- Connectors: Aluminium swivel hook
- Weight: 3kg
- Max user weight: 140kg
- Max fall arrest load: < 6kN
- Line material: 5mm galvanised wire
- Case material: Heavy duty nylon 66



## DEFENDER FALL ARREST BLOCK 3.3M WEBBING

### RGA3.3 WEB DEF

The Defender range is a lighter, more compact choice of fall arrest blocks. The RGA3.3 WEB features a webbing line and an aluminium swivel hook karabiner. The casing is produced from heavy duty aluminium. The top of the block contains a swivel with an opening for further attachment.

- Accredited to: EN 360:2002
- Connectors: Aluminium swivel hook
- Weight: 1.5kg
- Max user weight: 140kg
- Max fall arrest load: < 6kN
- Line material: 25mm UHMWPE webbing
- Case material: Aluminium



## DEFENDER FALL ARREST BLOCK 3.3M

### RGA3.3 DEF

Similar to the RGA3.3 WEB, this block features a galvanised wire cable, which makes the operation smooth and unproblematic. The fall indicator is comprised in the connector that has been coherently designed for most working at height applications.

- Accredited to: EN 360:2002
- Connectors: Aluminium swivel hook
- Weight: 2.2kg
- Max user weight: 140kg
- Max fall arrest load: < 6kN
- Line material: 5mm galvanised wire
- Case material: Heavy duty nylon 66



## DEFENDER FALL ARREST BLOCK - 9M

### RGA9 DEF

This variation of the defender range will ensure smooth and easy operations. Produced with galvanised wire cable to arrest fall situations. Approved to EN standards, this Defender block is robust, resilient and effective.

- Accredited to: EN 360:2002
- Connectors: Aluminium swivel hook
- Weight: 3.9kg
- Max user weight: 140kg
- Max fall arrest load: < 6kN
- Line material: 5mm galvanised wire
- Case material: Heavy duty nylon 66



## DEFENDER FALL ARREST BLOCK - 20M

### RGA20 DEF

The largest block in the Defender range of fall arrest products, the RGA20 DEF is lightweight with a fall indicating double action connector.

- Accredited to: EN 360:2002
- Connectors: Aluminium swivel hook
- Weight: 8.6kg
- Max user weight: 140kg
- Max fall arrest load: < 6kN
- Line material: 5mm galvanised wire
- Case material: Heavy duty nylon 66



**FALL INDICATOR**  
All our Defender Fall Arrest Blocks feature this fall indicator to easily identify that a fall has occurred.

## A GUIDE TO SAFE FALL CLEARANCES FOR RIDGEGEAR FALL ARREST BLOCKS

Consideration should be given to the first obstruction and not necessarily the lower level.

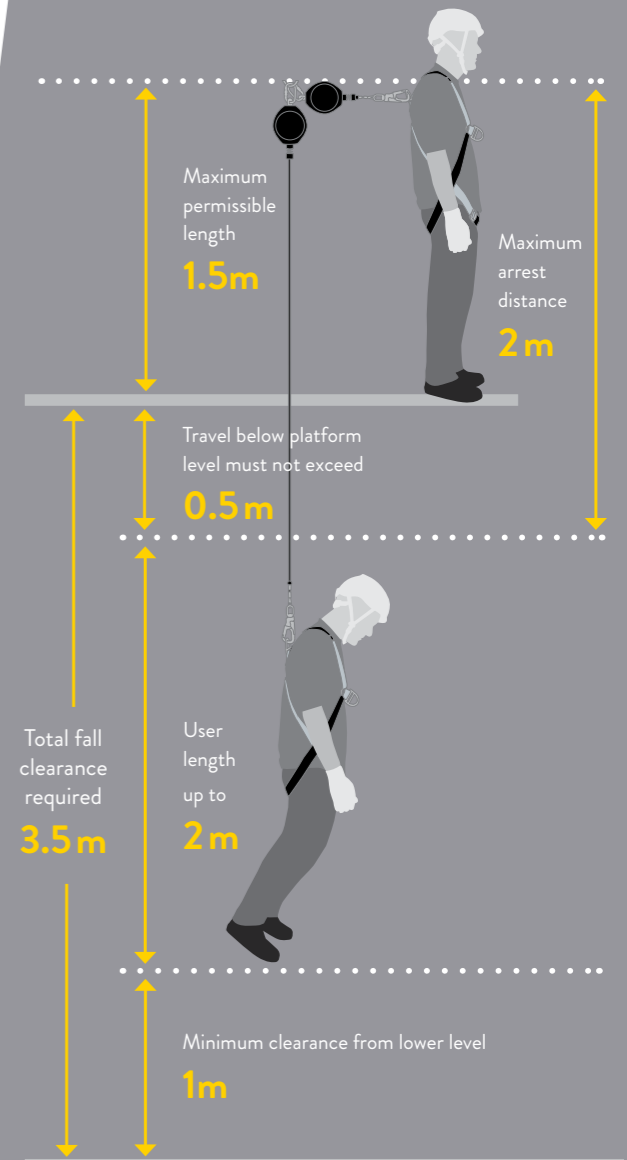

## RESCUE

Providing safe solutions to help in emergencies or difficult situations is very important to us.

That's why our range of rescue and confined space solutions are some of the best on the market. From rescue kits to tripods we have the products to suit your needs.

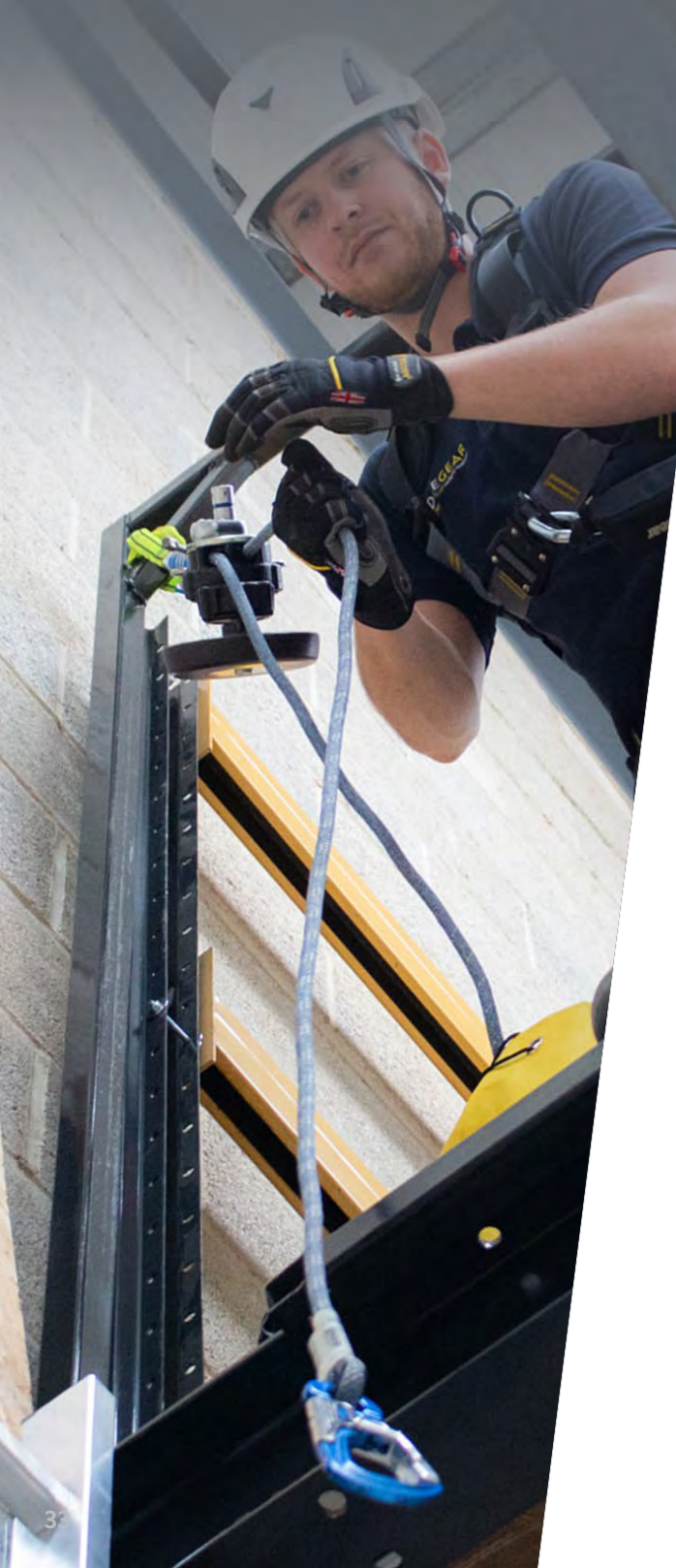

### RESCUE TRIPOD

#### RGR1



Our rescue tripod is portable, universally adjustable and easy to erect on site. It has adjustable lower and middle legs at 80mm intervals to adapt and adjust to the most demanding surfaces and varying ground conditions. There are two additional anchorage points (SWL 200kg) on the underside of the head for additional systems. This unit has many applications including confined access, entry, rescue, retrieval, manhole, silos and trenches.

Also available as three kits containing:  
**A RGR1 Tripod and a RGA4B Tripod Bracket**

/ **RGR1/TRIPODKIT1** also includes RGA4 Fall Arrest Block with Recovery Winch - 15m *SEE PAGE 30*

/ **RGR1/TRIPODKIT2** also includes RGA4 Fall Arrest Block with Recovery Winch -15m *SEE PAGE 30*  
RGK29 Tripod Bag *SEE PAGE 37*

/ **RGR1/TRIPODKIT3** also includes RGA4H Fall Arrest Block with Recovery Winch and Handle -15m *SEE PAGE 30*  
RGK29 Tripod Bag *SEE PAGE 37*

Accredited to: EN 795:2012, Type B  
Material: Aluminium cast  
Weight: 17.5kg  
Height: 1.7 – 2.7m  
Packed length: 1.4m  
Footprint span: 1.0 – 1.8m  
Safe working load (SWL): 200kg  
Fittings: EN795 attachment points

### RESCUE WINCH

#### RGR7

The RGR7 has a working length of 15m and 50m and is fitted with an up/down clutch-locking mechanism. Manufactured from steel, this winch has a 50cm diameter handle turn. One full handle turn will release approximately 48mm of cable to allow the worker to ascend / descend to safety. It can be fitted to the RGR1 tripod for use in confined space access when ladders or foot irons are not available.

Accredited to: EN 1496:2017 A & B  
Cable specification: 5mm galvanised steel wire  
Connector: RGK44  
Weight: 21.5kg (50m) 18kg (15m)  
Dimensions (mm): 210 x 340 x 210  
Safe working load (SWL): 140kg  
Gear ratio: 1:8.9



#### FALL INDICATOR

The RGR7 features a fall indicator to easily identify that a fall has occurred.

### TRIPOD BRACKET (TO FIT RGA4)

#### RGA4B



The tripod mounting bracket enables the safe attachment of an RGA4 fall arrest block. It includes a ball lock pin that is used when fitted to the RGR1 tripod.

Material: Steel  
Weight: 1.4kg  
Dimensions (mm): 340 x 90 x 165

### TRI-PULLEY

#### RGR2



Our tri-pulley has been specifically developed so that the RGA4 and RGR7 can be fitted together on the same RGR1 tripod. It is lightweight and features revolving side sheaves to enable easy wire rope and connector attachment.

Accredited to: EN 12278:2007 For rope ≤ 13mm  
Material: Stainless steel  
Weight: 390g  
Dimensions (mm): 104 x 25 x 70

### ISC D4 WORK/RESCUE DESCENDER

#### RGR16



The RGR16 Work/Rescue Descender features a unique and innovative progressive cam action which offers precise control at slow or fast speeds. The progressive cam works by way of one cam operating inside another cam to provide a mechanical advantage and smooth control. The RGR16 is a double-stop device with an antilock function whenever the operator lets go of the handle.

Accredited to: EN 12841:2006. ANSI Z359.4:2013  
For rope 10.5 – 11.5mm

Material: Aluminium  
Weight: 680kg  
Dimensions (mm): L 200 x W 83 x D 80 including handle  
WLL: 240kg.  
Breaking load: >16kN

### ISC SINGLE PULLEY

#### RGR17



The RGR17 is a small swing cheek pulley. This ISC lightweight pulley is made from high strength Aluminium and fitted with tamper-proof rivets

Accredited to: EN 12278:2007 For textile rope 10–13mm  
Material: Aluminium  
Weight: 87g  
Dimensions (mm): L 74 x W 45 x D 32  
Breaking load: 36kN

RIDGE RESCUE KIT

RGR14



The only rescue kit you'll need - Ridge Rescue is the perfect solution to rescue a worker in the event of a fall. Essential when it comes to performing quick, effective recovery, the kit enables you to raise or lower the casualty. Complete with either 100m, 50m, 20m for any rescue situation.

This kit contains;

- / Rescue device (MRG9 Easy) with 100m, 50m or 20m rope and 2 x RGK2P karabiners *SEE PAGE 24*
- / RGK26DC Slingky - 2m anchorage sling with wear sleeve *SEE PAGE 22*
- / Rescue pole
- / RGS4 Roll top weather-proof bag with carry straps *SEE PAGE 37*

Accredited to: EN 341:2011 and EN 1496:2017 (rescue device)  
EN 795:2012 B (Slingky),  
EN 362:2004 (karabiners)

Max descent rate: 0.8m/s  
Max descent load: 200kg  
Max lifting capacity: 140kg  
Length/Weight: 100m = 11kg, 50m = 8kg, 20m = 6kg  
Dimensions (mm): L 940 x W 370 x D 250

CRANE RESCUE KIT

RGR15



The RGR15 TC / 100 Tower Crane Rescue Kit is developed for the rescue of a casualty from tower cranes, gantry cranes or other tall structures. The easy to use system allows the rescuer to raise and lower a casualty to allow movement to a safe location.

The controlled rescue device within the kit is also designed to allow automatic self-  
evacuation, giving a limited maximum descent speed of 0.8m/s.

This kit contains;

- / Rescue device (MRG9 Easy) with 100m rope and 2x RGK2P *SEE PAGE 24*
- / RGK26/1 1m anchorage sling *SEE PAGE 22*
- / RGK1 17mm Screwgate Karabiner x2 *SEE PAGE 24*
- / RGK2P 17mm twistlock karabiner with captive pin x2 *SEE PAGE 24*
- / RGK12 10mm Screwgate Delta link *SEE PAGE 23*
- / RGR2 Tri Pulley *SEE PAGE 34*
- / RGR6 Rescue Triangle *SEE PAGE 36*
- / RGR11 Rescue Stretcher *SEE PAGE 36*
- / RGS1 Kit Bag *SEE PAGE 38*
- / RGS2 25L backpack x2 *SEE PAGE 46*
- / 6mm Tagline 100m
- / Protective case

Accredited to: EN 341:2011 (rescue device)  
Max descent rate: 0.8m/s  
Max descent load: Class A 100kg / Class B 200kg  
Max lifting capacity: 140kg  
Weight: Descender unit 1.6kg with karabiner excluding rope  
Dimensions (mm): L 325 x W 95 x D 160 including karabiner

RESCUE STRETCHER

RGR11



This robust, flexible and lightweight stretcher allows easy movement in the event of a rescue. It is combined with horizontal and vertical lifting straps and a dedicated carry bag. Manufactured in conformance with CE93/42/EEC Class 1.

The kit includes;

- / SLIX100 Rescue Stretcher
- / Hauling strops and connectors
- / Storage kit bag

Accredited to: CE93/42/EEC Class 1  
Size (mm): L 2300 x W 915  
Max recommended user weight: 400kg

RESCUE TRIANGLE

RGR6



Easy to fit in an emergency, our rescue triangle is an efficient approach to ascending or descending a casualty into a safe position. It can be arranged in a matter of seconds, but must only be used in the event of a rescue. Adjustable for a range of user sizes and ages.

- / Quick release buckles for rapid ingress/egress
- / Adjustable to casualty size
- / High visibility colouring with self storage pocket
- / Colour coded stitch patterns & webbing
- / Self storage pocket
- / 3 metal D rings for anchor connection

Accredited to: EN 1498:2006 Class B (Non PPE)  
Material: Polyester webbing & PVC  
Weight: 1.15kg  
Dimensions (mm): PVC - 1100 x 780

TRAUMA SUSPENSION STRAPS (PAIR)

RGK42



Trauma straps help to prevent the effects of toxic shock if the user is left suspended. The leg straps of a harness can cause loss of circulation to the legs and feet in the event of a fall. Standing on these straps will relieve the pressure to the groin and release the tension within the webbing. Can be fitted to all our harnesses.

Material: Polyester

## STORAGE

It's important to store all of your equipment in a safe and dry place.

We have many different bags that have been considered for all storage purposes.



### 3.8L TOOL BUCKET

#### RG/TOOL BUCKET



Large storage container to load tools into when working at height. It comes with a drawstring closure making tools easily accessible, whilst also protecting them from the elements. Additional connection points on the outer allow safe stowing of any excess or frequently used items. The filter at the bottom of the bag ensures liquid or dirt doesn't build up. There are also connection points at the top allowing attachment to the tool loops of a work positioning harness belt with connectors.

- / Attachment points on outer bag
- / Secure drawstring closure
- / Underside filter

Material: Tarpaulin  
Size (mm): H 253 x W 140 x D 140  
Max Weight Capacity: 5kg

### TRIPOD BAG

#### RGK29



Specifically designed to store the RGR1 tripod, this bag is heavy duty and features a full length top zip and two carry handles which wrap around the bag for extra strength.

Material: Heavy duty nylon  
Size (mm): H 430 x W 1570 x D 250

### ROPE AND RESCUE BAG

#### RGS4



Storage of the Ridge Rescue kit and other rescue and/or rope equipment. To hold various rescue equipment and rope, this roll-top weather-proof bag with carry straps is a great solution for holding lots of equipment.

- / Weather-proof

Material: PVC  
Size (mm): H 950 x W 380 x D 210

### KIT BAG

#### RGS1



A perfect fit to store harnesses and lanyards conveniently in one place. It features a carry handle and a transparent pocket to store paperwork.

- / Carry handle
- / Transparent front pocket

Material: Textured nylon  
Size (mm): H 285 x W 355 x D 125

### 20L PREMIUM BACKPACK

#### RGS8



Our premium backpack at 20l is perfect for comfortably carrying a large amount of gear. Designed to carry high on the back allowing easy access to a climbing harness, and with built in breathable foam padding for extra comfort. The adjustable sternum strap improves security and stability when active. With two spacious main compartments, each with their own additional inner pocket, gear can be sectioned for easier access. It also features outer attachment points and outer side pockets.

- / Attachment points on outer bag
- / Sternum strap
- / Breathable foam padding

Material: Tarpaulin (body), TPU (top cover)  
Size (mm): H 450 x W 280 x D 160  
Weight: 570g

### PUMP BAG

#### RGS5



Our branded pump bag is a cost-effective way of storing your safety gear. It is made from nylon and features a drawstring closure.

- / Drawstring closure

Material: Textured nylon  
Size (mm): H 470 x W 360

### 25L BACKPACK

#### RGS2



The perfect solution for storing all types of equipment. Lightweight and an ideal size - benefits include extra padding for comfort and small compartments for additional storage.

- / Extra padding
- / Small storage compartments

Material: Textured nylon  
Size (mm): H 460 x W 290 x D 250

### 14L BACKPACK

#### RGS6



Our branded 14L backpack is produced from nylon and is a cost effective way of storing your safety equipment. It is lightweight, with shoulder straps for easy carrying.

- / Carry handle
- / Shoulder straps
- / Lightweight

Material: Abrasion resistant nylon  
Size (mm): H 380 x W 260 x D 140

### 50L BACKPACK

#### RGS3



A general-purpose storage bag ideal for use in all weathers. Features comfort back pad, padded waist belt and shoulder straps. Manufactured from high grade welded tarpaulin material makes this bag durable and helps to repel water. Features draw-string closure and small front pocket for extra essentials.

- / Comfort back pad and padded waist belt
- / Shoulder straps
- / Drawstring closure
- / Small front pocket

Material: PVC Tarpaulin  
Size (mm): H 700 x W 360 x D 300  
Max load rating: 20kg

## TOOL LANYARD

Our Tool Lanyard range is specifically designed to eliminate the danger of dropping tools, a significant cause of injury in the workplace, and keep them close at hand.

They come in three different, colour-coded ranges so whatever your requirement, we have a lanyard to suit your needs. All complimented by a great range of unique connectors, making it easy to attach almost any existing tools.



### TOOL LANYARD WITH CHOKE LOOP, KINETIC® RTLK1



Length: 1.25m  
Web material: 20mm / 25mm water repellent polyester  
Webbing strength: >1000kg  
Tool attachment: 210mm choke loop  
Max capacity: 10kg

### TOOL LANYARD WITH CHOKE LOOP, BELT ATTACHMENT 'O' RING, KINETIC® TWIN LEG RTLK3



Length: Kinetic 1.25m / Standard 1.22m  
Web material: 20mm / 25mm water repellent polyester  
Webbing strength: >1000kg  
Tool attachment: 210mm choke loop & 2 x 50mm 'O' ring  
Max capacity: Kinetic 10kg / Standard 3kg

## SHOCK ABSORBER RANGE

In the event of dropping a heavy tool, these lanyards significantly minimise the risk of the user being pulled off a ladder or platform.

### TOOL LANYARD WITH CHOKE LOOP, SHOCK PACK RTLA1



Length: 1.25m  
Web material: 20mm water repellent polyester  
Webbing strength: >1000kg  
Tool attachment: 210mm choke loop  
Max capacity: 5kg

### TOOL LANYARD WITH CHOKE LOOP, BELT ATTACHMENT 'O' RING, SHOCK PACK RTLA2



Length: 1.25m  
Web material: 20mm water repellent polyester  
Webbing strength: >1000kg  
Tool attachment: 210mm choke loop & 50mm 'O' ring  
Max capacity: 5kg

### TOOL LANYARD WITH CHOKE LOOP, BELT ATTACHMENT 'O' RING, KINETIC RTLK2



Length: 1.25m  
Web material: 20mm / 25mm water repellent polyester  
Webbing strength: >1000kg  
Tool attachment: 210mm choke loop & 50mm 'O' ring  
Max capacity: 10kg

## ELASTIC RANGE

Webbing with added elastication for ease of movement and convenience and basic energy absorbing properties.

### TOOL LANYARD WITH CHOKE LOOP, ELASTIC RTLE1



Length: 0.6m (extending to 1.25m)  
Web material: 20mm water repellent polyester  
Webbing strength: >1000kg  
Tool attachment: 190mm choke loop  
Max capacity: 5kg

### TOOL LANYARD WITH CHOKE LOOP, BELT ATTACHMENT 'O' RING, ELASTIC RTLE3



Length: 0.6m (extending to 1.25m)  
Web material: 20mm water repellent polyester  
Webbing strength: >1000kg  
Tool attachment: 190mm choke loop & 50mm 'O' ring  
Max capacity: 5kg

### TOOL LANYARD WITH BUNGEE CHOKE, ELASTIC RTLE2



Length: 0.6m (extending to 1.25m)  
Web material: 20mm water repellent polyester  
Webbing strength: >1000kg  
Tool attachment: 190mm choke loop  
Max capacity: 1kg

### TOOL LANYARD WITH CHOKE LOOP, TWIN LEG ELASTIC RTLE4



Length: 0.6m (extending to 1.25m) x2  
Web material: 20mm elasticated polyester  
Webbing strength: >1000kg  
Tool attachment: 190mm choke loop x2  
Max capacity: 5kg

## TOOL LANYARD SELECTOR

Use our handy guide to select the correct Tool Lanyard range and capacity for some commonly used tools.

Please be aware this is only a guide, you should always weigh your own tools before deciding which Tool Lanyard to use. Check individual Tool Lanyard information for actual capacity.

### SHOCK ABSORBER

Capacity ranges of up to 5kg and 10kg



### ELASTIC

Capacity ranges of up to 1kg and 5kg



### STANDARD

Capacity ranges of up to 1kg and 3kg



## TOOL LANYARD

### STANDARD RANGE

Made from high quality flat webbing for basic tool restraint.

#### TOOL LANYARD WITH CHOKE LOOP RTLS1



Length: 1.22m  
Web material: 20mm water repellent polyester  
Webbing strength: > 1000kg  
Tool attachment: 190mm choke loop  
Max capacity: 3kg

#### TOOL LANYARD WITH CLIP BUCKLE, 3 CHOKE LOOPS RTLS2



Length: 1.22m  
Web material: 20mm water repellent polyester  
Webbing strength: > 1000kg  
Tool attachment: 190mm choke loop (as RTLS2A)  
Max capacity: 1kg

#### TOOL LANYARD ACCESSORY, 3 CHOKE LOOPS RTLS2A

For use with the RTLS2



Length: 0.26m  
Web material: 20mm water repellent polyester  
Webbing strength: > 1000kg  
Tool attachment: 190mm choke loop  
Max capacity: 1kg

#### TOOL LANYARD WITH CHOKE LOOP, BELT ATTACHMENT 'O' RING RTLS3



Length: 1.22m  
Web material: 20mm water repellent polyester  
Webbing strength: > 1000kg  
Tool attachment: 190mm choke loop  
Max capacity: 3kg

#### TOOL LANYARD WITH CHOKE LOOP, TWIN LEG RTLS4



Length: 1.22m x2  
Web material: 20mm water repellent polyester  
Webbing strength: > 1000kg  
Tool attachment: 190mm choke loop x2  
Max capacity: 3kg

#### TOOL LANYARD, WRIST RTLWR1



**WRIST LANYARD**  
Length: 0.32m  
Web material: 20mm WR polyester  
Webbing strength: > 1000kg  
Tool attachment: D-ring  
Max capacity: 1.5kg

**EXTENSION STRAP**  
Length: 0.3m  
Web material: 9mm polyester  
Webbing strength: > 400kg  
Tool attachment: Swivel snap hooks  
Max capacity: 1.5kg

### CONNECTORS

We also have a range of tethering options that can be easily choked around tools with a captive handle or waisted tools.

#### TOOL LANYARD ACCESSORY, 5 X TOOL TIE WITH BOLT TIGHTENING RTLX1



USE WITH RTLW3

Length: 240mm  
Width: 10mm  
Closure type: 7mm hex bolt  
Max capacity: 1kg

#### TOOL LANYARD ACCESSORY, 5 X TOOL TIE WITH HOLED STEEL CONNECTOR RTLX2



USE WITH RTLX1

Length: 240mm  
Width: 10mm  
Closure type: 7mm hex bolt  
Max capacity: 1kg

#### TOOL LANYARD ACCESSORY, 5 X D RING WITH TOOL CONNECTOR RTLW3



USE WITH RTLX1

Length: 70mm  
Material: 20mm water repellent polyester  
Attachment type: Flat loop with D ring  
Max capacity: 1kg

#### TOOL LANYARD ACCESSORY, KARABINER, STEEL SNAPGATE 1 RTLCL1



USE WITH RTLRL1

Gate opening: 8mm  
Size: 50mm x 25mm  
Closure type: Snapgate  
Max capacity: 1kg

#### TOOL LANYARD ACCESSORY, KARABINER, STEEL SNAPGATE 2 RTLCL2

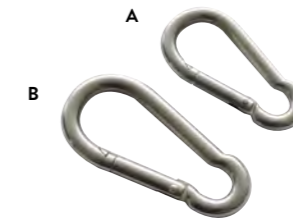

AVAILABLE IN TWO SIZES

Gate opening: A: 6mm / B: 8mm  
Size: A: 50mm x 25mm / B: 60mm x 30mm  
Closure type: Snapgate  
Max capacity: A: 3kg / B: 5kg

#### TOOL LANYARD ACCESSORY, KARABINER, STEEL SCREWGATE RTLCL3

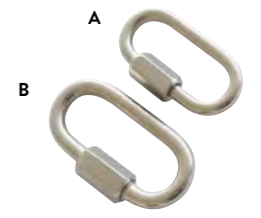

AVAILABLE IN TWO SIZES

Gate opening: A: 5mm / B: 5mm  
Size: A: 40mm x 20mm / B: 50mm x 25mm  
Closure type: Screwgate  
Max capacity: A: 5kg / B: 10kg

#### TOOL LANYARD ACCESSORY, 2MM CORD RTLRL1



USE WITH ANY RTLCL KARABINER

Length: Available in 10m lengths  
Material: 2mm nylon cord  
Max capacity: 1kg

### CONNECTOR SELECTOR

We're sure you'll find your own favourite and safest way of connecting depending on your tools, but here is a short guide to the most common tools and recommended methods of tethering.



LIGHTWEIGHT TOOLS WITH OPENINGS

Accessory Cord RTLRL1

use with any RTLCL if needed



LIGHTWEIGHT TOOLS WITHOUT OPENINGS

Tool Ties RTLX1/2

use with any RTLCL or RTLW3 if needed



HEAVIER TOOLS WITH A WAIST OR OPENING

Choke Loop

Standard on all our tool lanyards

## TRAINING

At RIDGEGEAR we understand the dangers of working at height and the importance of correct and in-depth height safety training when working in this type of environment.



**We offer training to both the industrial and adventure industries. Tailored to fit the requirements for either industry.**

We know it is paramount to not only ensure the worker's safety, but also the people around them. Whether this be fellow work colleagues or customers unfamiliar with the dangers at height.

To make sure workers at height have the best possible preparation, we offer an array of training courses designed to equip any delegate with the right knowledge and practical skills to work safely and effectively within their given area.

Your training can take place either on our site in Leek, Staffordshire or on your own site (if suitable). Our own site has a training frame with various functions for practical courses and a classroom for theory courses.

Our knowledgeable and friendly trainers will ensure you have a fantastic training experience.

### INDUSTRIAL TRAINING

These training courses will ensure that delegates working within the industrial industry will be prepared and competent to complete their day to day tasks.

Categories:

- / Working at height
- / Rescue
- / Warehouse
- / Inspection
- / Confined space

### ADVENTURE TRAINING

Our adventure training caters for instructors working in the recreational industry. Our tailor-made service is designed to be specific to your adventure park/setting, ensuring you get fit for purpose training.

Categories:

- / Instructor
- / Rescue
- / Inspection

Upon completion of any of our training courses you will receive a RIDGEGEAR certificate which is valid for three years.

For any further information or to check availability please visit/contact:  
[www.ridgegear.com/training-courses](http://www.ridgegear.com/training-courses)  
[training@ridgegear.com](mailto:training@ridgegear.com)





PRODUCT SELECTORS Use the tables below to choose the right harness, lanyard or connector for you.

HARNESSES



	Front D	Rear D	Side D	Reflective	Fast Fit Buckles	Rescue Strap	Waist Comfort Pad	Back/Shoulder Comfort Pad	Leg Comfort Pads	Ventral	Tool Loops
RGH1											
RGH2	■	■									
RGH2 FAST FIT	■	■			■						
RGH2 ECO	■	■									
RGH2 GLOW	■	■		■							
RGH2 BIGGUY	■	■									
RGH4	■	■	■				■				■
RGH5	■	■				■					
RGH5 GLOW	■	■		■		■					
RGH5 SUPER GLOW	■	■		■		■					
RGH6	■	■	■		■		■	■			■
RGH12										■	■
RGH14 & RGH 14 RR	■	■									■
RGH15	■	■	■		■		■	■	■	■	■
RGH16	■	■	■		■		■	■	■	■	■
RGH35	■	■			■				■		

LANYARDS



	Single	Twin	Fall Arrest	Work Restraint	Webbing	Rope	Elasticated	Self Retracting	Adjustable
RGL1	■		■		■				
RGL1 BIG GUY	■		■		■				
RGL1 MINI	■		■		■				
RGL2	■		■		■	■			
RGL3		■	■		■				
RGL3 BIG GUY		■	■		■				
RGL4	■			■	■				
RGL5	■			■	■				
RGL5R	■			■	■	■			
RGL6	■		■		■		■		
RGL9		■	■		■		■		
RGL11	■		■		■	■			
RGL12	■		■		■				■
RGL13	■		■		■				■
RGL14		■	■	■	■				
RGL16		■	■		■				■
RGL19		■	■		■				■
RGL20	■		■		■		■		
RGL28		■	■		■			■	
RGL29	■		■		■				
RGL30		■	■		■				
RGL31	■		■		■				
RGL60		■	■		■				

CONNECTORS



	Material	Gate Opening (mm)	External Length (mm)	Closure Type	MBS	Weight (g)	Optional Captive Pin	Captive eye
RGK1	Steel	17	107	Screwgate	23kN	170		
RGK1/A	Aluminium	19	111	Screwgate	24kN	80		
RGK1/AT	Aluminium	19	111	Twistlock	24kN	86		
RGK2	Steel	17	107	Twistlock	25kN	215		
RGK2P	Steel	17	107	Twistlock	25kN	215	■	
RGK3	Steel	24	119	Twistlock	50kN	300		
RGK4	Aluminium	22	112	Twistlock	24kN	83		
RGK5	Steel	56	229	Twistlock	30kN	750	■	
RGK6	Aluminium	54	240	Twistlock	23kN	351	■	
RGK10	Steel	19	144	Screwgate	23kN	275		■
RGK11	Aluminium	60	248	Double action	23kN	480		■
RGK11/SL	Aluminium	55	218	Double action	25kN	264		■
RGK12	Steel	10	73	Screwgate	27kN	87		
RGK15	Steel	12	104	Triple action	40kN	215	■	
RGK18	Steel	18	135	Triple action	45kN	300		■
RGK19	Steel	23	131	Triple action	45kN	260		■
RGK20	Steel	10	86	Screwgate	45kN	153		■
RGK44	Aluminium	22	180	Triple action	30kN	177		■
RGK45	Steel	21	173	Double action	23kN	345		■
RGK50	Alu Body / Steel Gate	18	185	Double Action	23kN	414		■
RGK88	Aluminium	62	248	Double action	23kN	640		■

INSPECTING SAFETY HARNESSES AND LANYARDS

It is recommended that the user inspects their harness or lanyard in a safe place before every use. Users must ensure that the harness is the correct size, has sufficient adjustment and acceptable comfort. Lanyards should be the correct type and length, and have suitable connectors. Remember that harnesses and lanyards must be periodically inspected by a competent person. If you don't understand what is an acceptable level of damage then further training is required.

CORRECT FIT

Ensure you have been given the correct training by a competent person before using equipment. Harnesses must be fitted correctly.

PLASTIC FITTINGS

Including web-ties and back plate, visually check for cuts, breaks, distortion and chemical damage.

METAL FITTINGS

Check for any corrosion, cracks, sharp edges, damage and irregular wear of the fittings and functionality of the buckles. Ensure all moving mechanisms operate correctly. If any damage is found the harness must be taken out of use.

TRACEABILITY

Keep records of where and when you purchased the harness or lanyard. We recommend recording all inspections before use and completing a risk assessment. Ensure that the product markings and serial number are legible.

STITCHING

Check for broken, loose, worn or abraded stitches or severely discoloured stitching. Most harnesses are made with a ripstitch indicator and a warning label – check this is still intact.

WEBBING

Check all webbing for irregular wear, especially around the hardware. Also check for cuts, abrasions, tears, scorch marks, burns, chemical attack, ink and severely discoloured patches.

SHOCK ABSORBER

Ensure the absorber pack shows no sign of activation, and remains secure in the protective cover.

CONNECTORS (AT BOTH ENDS)

Look for deformation, damage such as corrosion, sharp edges and cracks. Check the functionality - and that the keeper opens and closes freely.



## USEFUL INFORMATION

### HOW TO FIT A SAFETY HARNESS

Our step-by-step guide to the correct procedure.

A safety harness must be worn correctly to ensure that, in the event of a fall, it works to its design potential and does not cause additional injury.

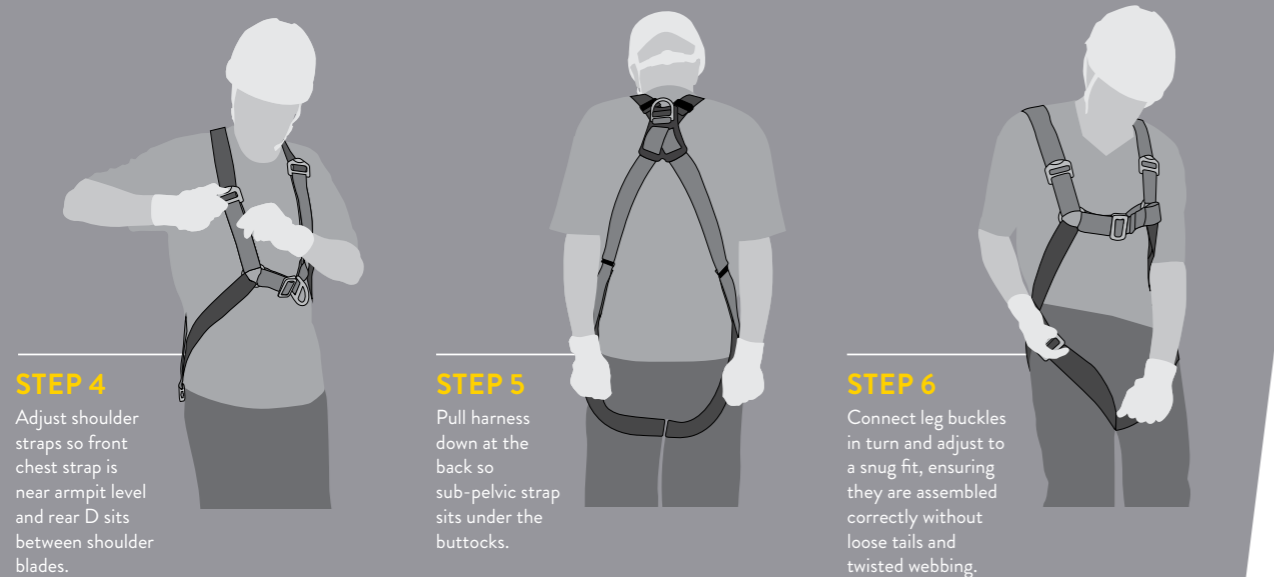
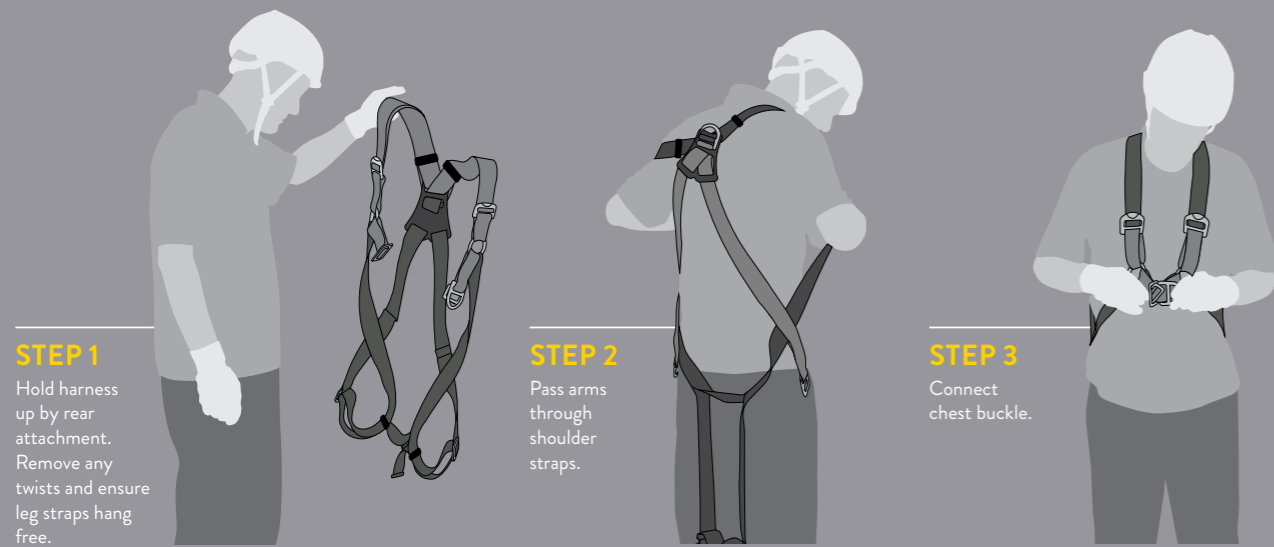

### CHECKLIST

1. Ensure that the right harness is used for the job.
2. Check that the harness has been inspected (see our inspection guide for details)
3. See that all clips and connectors are tightened, adjusted and attached.
4. Make sure that the webbing is adjusted to suit your body size – leaving the harness loose around the legs and chest may feel more comfortable BUT in the event of a fall, the sudden jolt that occurs when the slack is taken up can cause serious damage to the body; especially in the groin area and internal organs.

### HARNESS SIZE GUIDES

Correct sizing is essential to the safety and comfort of a Safety Harness. Use these tables to help select the appropriate size and feel free to give us a call if you need any assistance

#### RGH1 / RGH2 / RGH5

Size	SMALL	STANDARD	LARGE	X-LARGE
<b>A Chest</b>	36 - 42" 91 - 107cm	42 - 50" 107 - 127cm	50 - 54" 127 - 137cm	54 - 58" 137 - 147cm
<b>B Waist</b>	30 - 36" 76 - 91cm	36 - 44" 91 - 112cm	44 - 48" 112 - 122cm	48 - 52" 122 - 132cm
<b>C Hips</b>	38 - 44" 97 - 112cm	44 - 52" 112 - 132cm	52 - 56" 132 - 142cm	56 - 60" 142 - 152cm

#### RGH15 / RGH16

Size	STANDARD	LARGE
<b>A Chest</b>	36 - 50" 91 - 127cm	46 - 58" 117 - 147cm
<b>B Waist</b>	30 - 44" 76 - 111cm	40 - 52" 102 - 132cm
<b>C Hips</b>	38 - 52" 96 - 132cm	48 - 60" 122 - 152cm

#### RGH4 / RGH6

Size	SMALL	STANDARD	LARGE	X-LARGE
<b>A Chest</b>	36 - 42" 91 - 107cm	42 - 50" 107 - 127cm	50 - 54" 127 - 137cm	54 - 58" 137 - 147cm
<b>B Waist</b>	30 - 44" 76 - 111cm	30 - 44" 76 - 111cm	38 - 52" 96 - 132cm	38 - 52" 96 - 132cm
<b>C Hips</b>	38 - 44" 96 - 112cm	44 - 52" 112 - 132cm	52 - 56" 132 - 142cm	56 - 60" 142 - 152cm

#### RGH12

Size	SMALL	STANDARD
<b>B Waist</b>	16 - 39" 40 - 100cm	16 - 49" 40 - 125cm
<b>D Leg</b>	10 - 27" 25 - 69cm	10 - 33" 25 - 84cm

#### RGH14 / RGH14 RR

Size	X-SMALL	SMALL	STANDARD
<b>Height</b>	42 - 54" 107 - 137cm	50 - 67" 127 - 170cm	62 - 76" 157 - 193cm
<b>A Chest</b>	20 - 28" 51 - 71cm	25 - 36" 64 - 91cm	31 - 53" 79 - 135cm
<b>B Waist</b>	18 - 25" 46 - 64cm	23 - 30" 58 - 76cm	25 - 46" 64 - 117cm
<b>C Hips</b>	20 - 29" 51 - 74cm	27 - 37" 69 - 94cm	33 - 54" 84 - 137cm

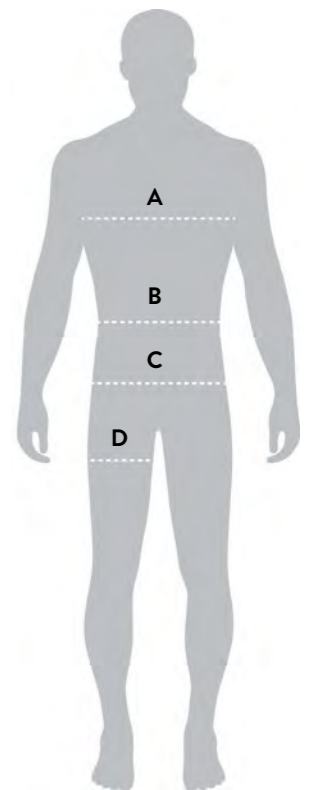

### RECOMMENDED USER WEIGHTS

It is important to understand that each fall arrest product you use in conjunction with our harnesses, such as lanyards and blocks have different maximum user weights between 100kg and 140kg. This is a guide to help you understand the differences and should give clarity that the harness does not determine the user weight.

Product	Fall Arrest Lanyards	Big Guy Fall Arrest Lanyards	Fall Arrest Blocks	Defender Fall Arrest Blocks
<b>Max. User Weight</b>	100kg	140kg	140kg	140kg



**RIDGEGEAR LIMITED**

Nelson Street  
Leek  
Staffordshire  
ST13 6BB

Telephone: +44 (0)1538 384 108  
Email: [sales@ridgegear.com](mailto:sales@ridgegear.com)

[ridgegear.com](http://ridgegear.com)

PART OF THE UNITEX GROUP



This brochure was produced using 100% recycled paper, once finished with please recycle responsibly.



Q05822